

Avcath

Wearable Urinary Catheterization Simulator

USER MANUAL

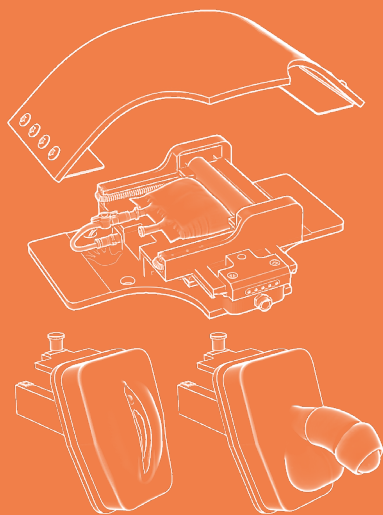

Customer Assistance

302-562-2110

Technical Support

302-562-2040

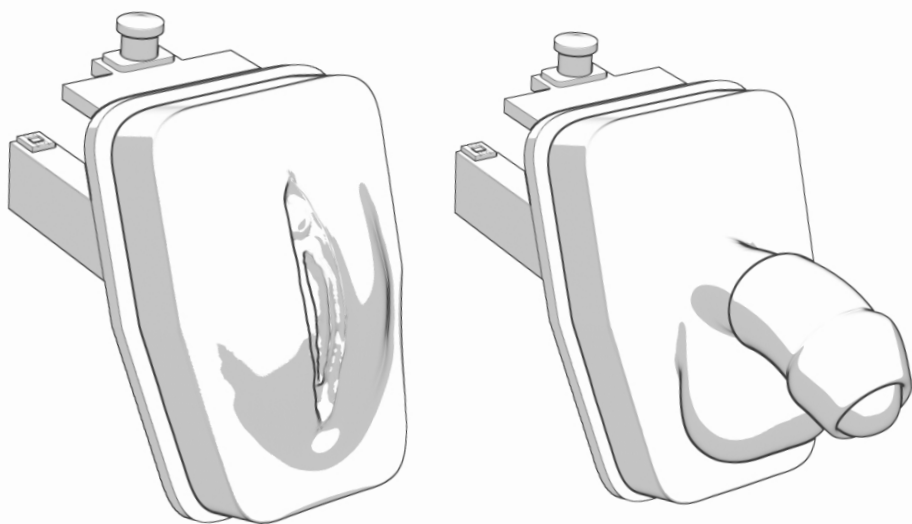
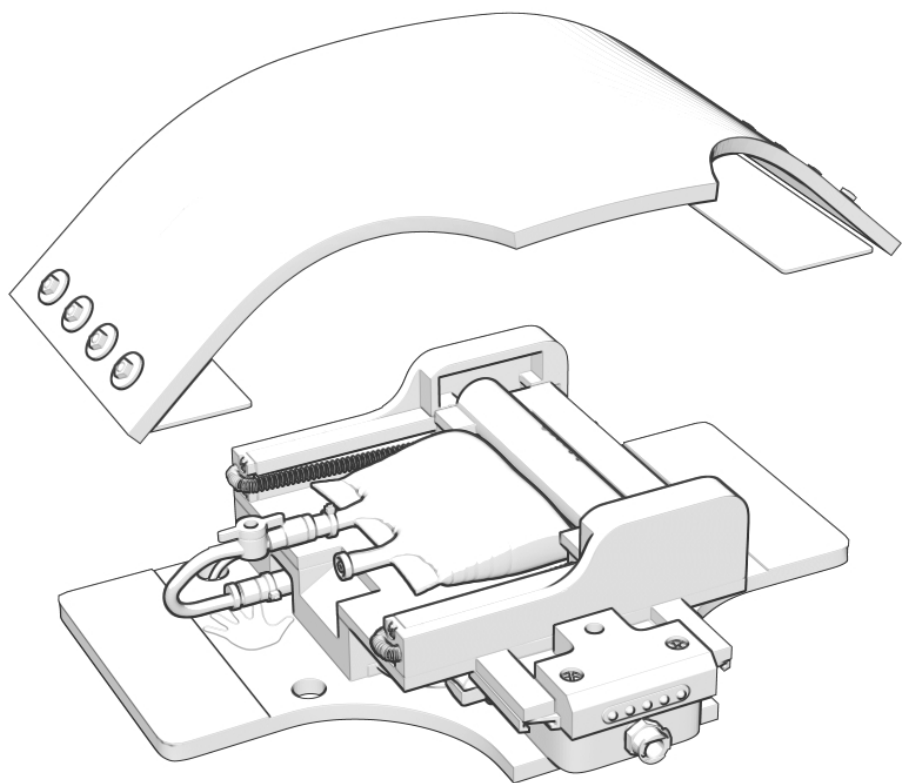



WELCOME TO YOUR AVCATH!

URINE OUTPUT

Once the catheter is in the bladder compartment, urine will flow from the compartment out the catheter.

BLADDER PALPATION

The bladder bag can be felt through the abdomen area, allowing the learner to feel for a full bladder and apply external bladder pressurization.

BLADDER SCANNING

The Avcath is compatible with bladder scanners for use in your simulations.

SENSORY FEEDBACK

SPs are cued through a light vibration around their mid-section when the catheter enters the bladder. For the female genitalia, the SP is also cued when the catheter enters the urethra.

WHAT'S INCLUDED

- Avcath: wearable technology for use with standardized patients.
- Female and male genitalia with removable foreskin
- 1 filled 500ml bag of standard urine (to be used for non-urine analysis simulation)
- Battery charger
- Façade Plate
- Disposable kit:
 - Mineral Oil with dispenser
 - 5 Blue Pads
 - 5 Bard 14 Fr Lubri-sil Foley Catheters
 - 5 Empty IV bags
 - Yellow Food Dye
 - Funnel
 - Wrench
 - 10 Small Finger Cots
 - Spear Tool

GETTING STARTED

Watch the instructional video on the customer portal.

1 Connect the genitalia.

- a** Pull up the Spring Plunger and twist it slightly to the right, and gently let go to lock the pin.

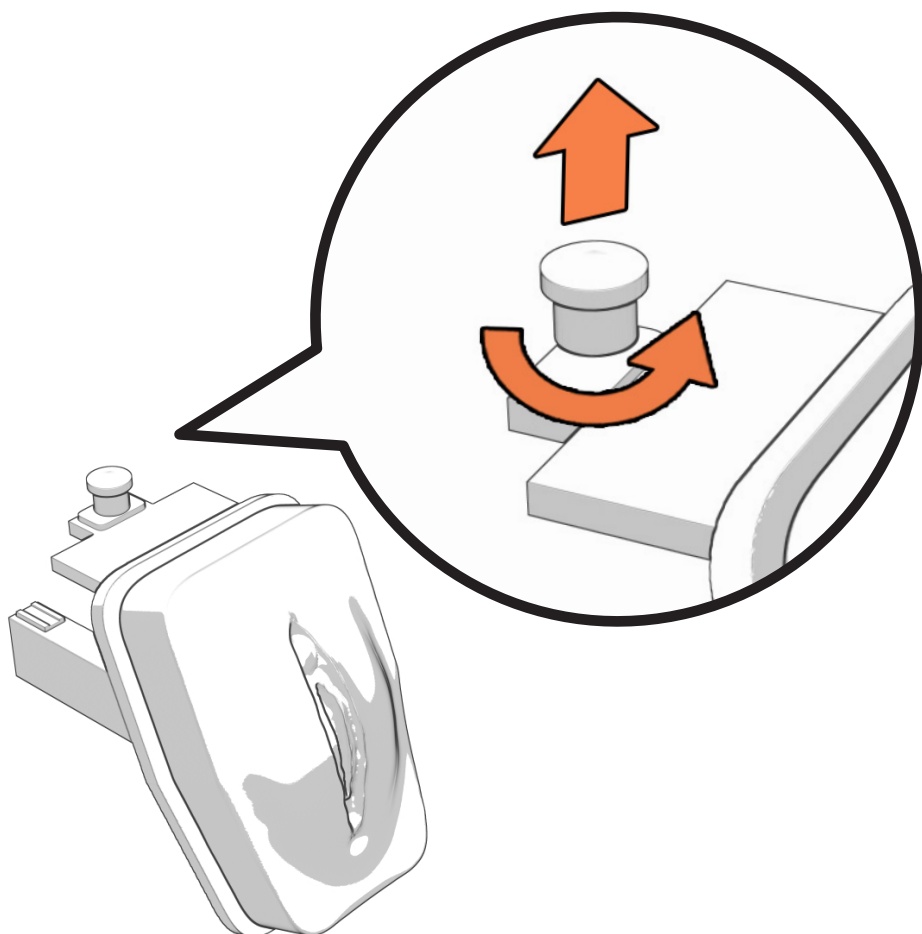

- b** Flip the entire device over. Have the yellow compartment slightly off the edge of a table.

- C** Align both of the rectangular beige colored carriages on the genitalia with the pointed edge of the guide rails on the Avcath.

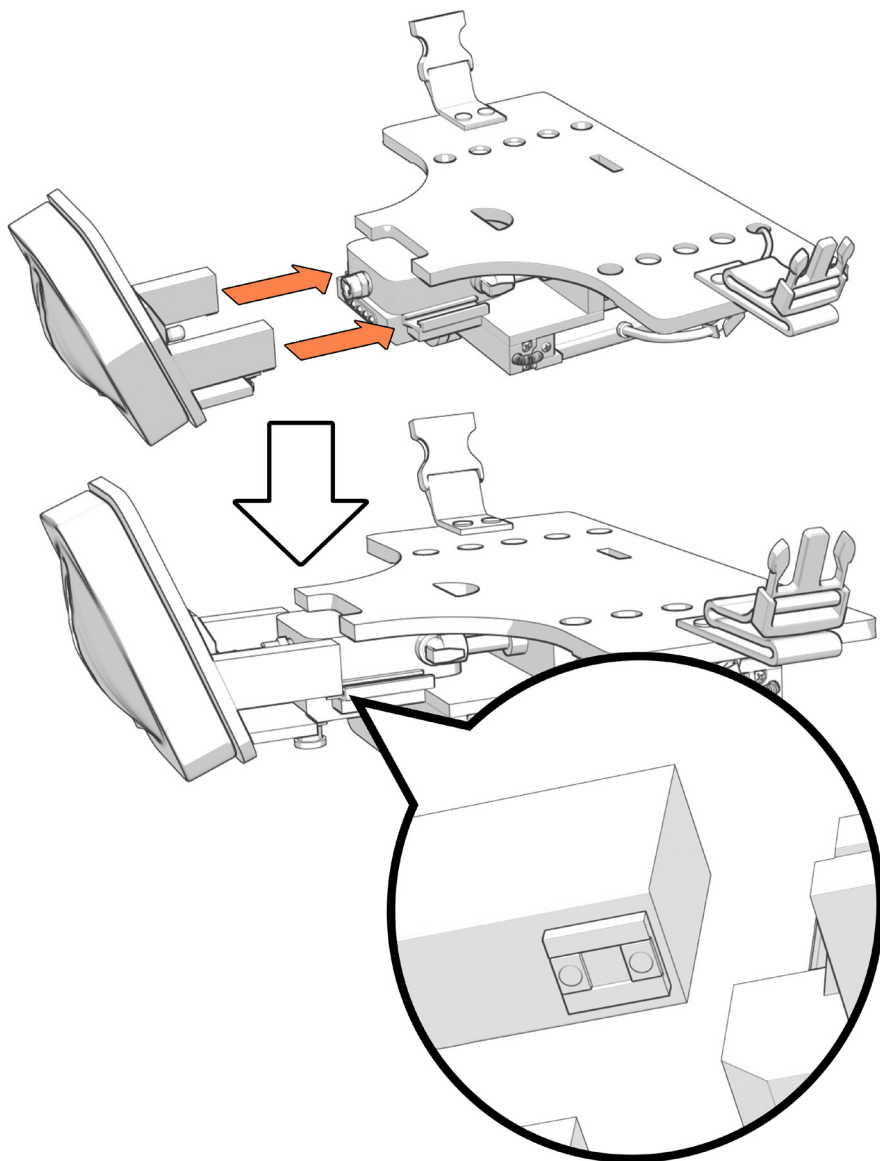

- d** Slide the carriages in all the way down the guide rails until the metal fitting on the genitalia meets the metal housing on the yellow compartment.

- e** Lightly lift the yellow compartment until the metal fitting on the genitalia slides into the metal fitting on the yellow compartment. You should hear a small “click” when the metal fitting is all the way in.

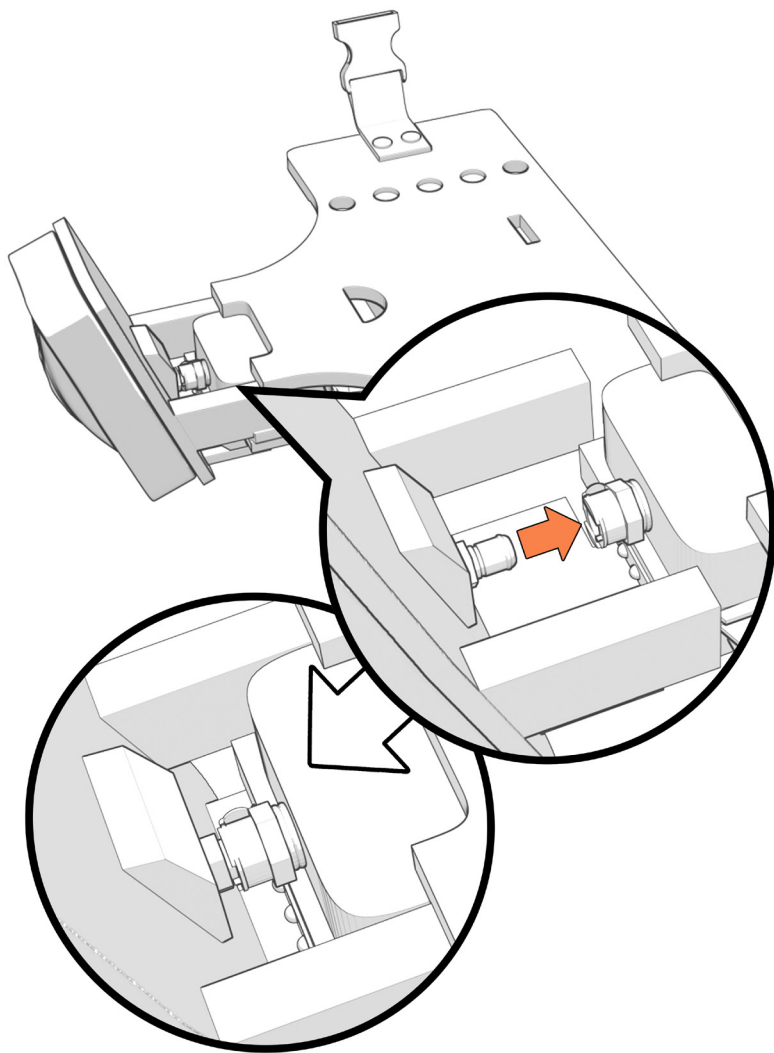

- f** Turn the device back over. Gently lift slightly up on the spring plunger and twist slightly to the right to let the head to all the way down. The genitalia should be locked and sturdy.

g

If using the foreskin with the male genitalia, put the foreskin on the genitalia and rub aquagel or an equivalent lubricant, to lubricate between the foreskin and the tip of the genitalia where the learner would push back the foreskin for catheterization.

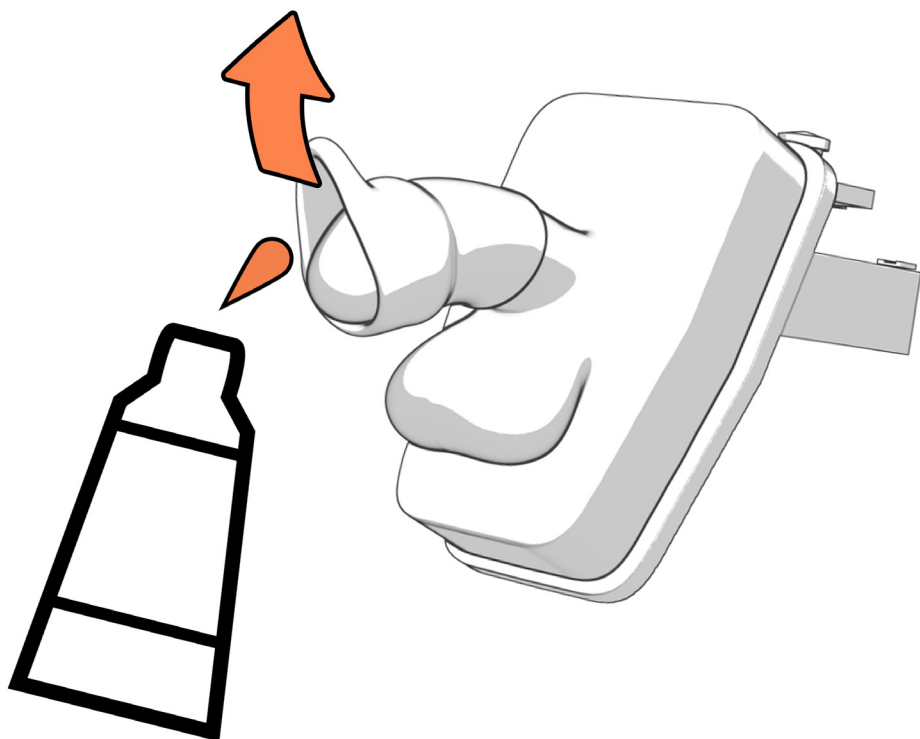

2

Insert fluidics

a

Remove any excess air from the urine bag.

- b** Place one hand on center of handle. Place other hand on the handprint located on the left side of the abdomen plate.

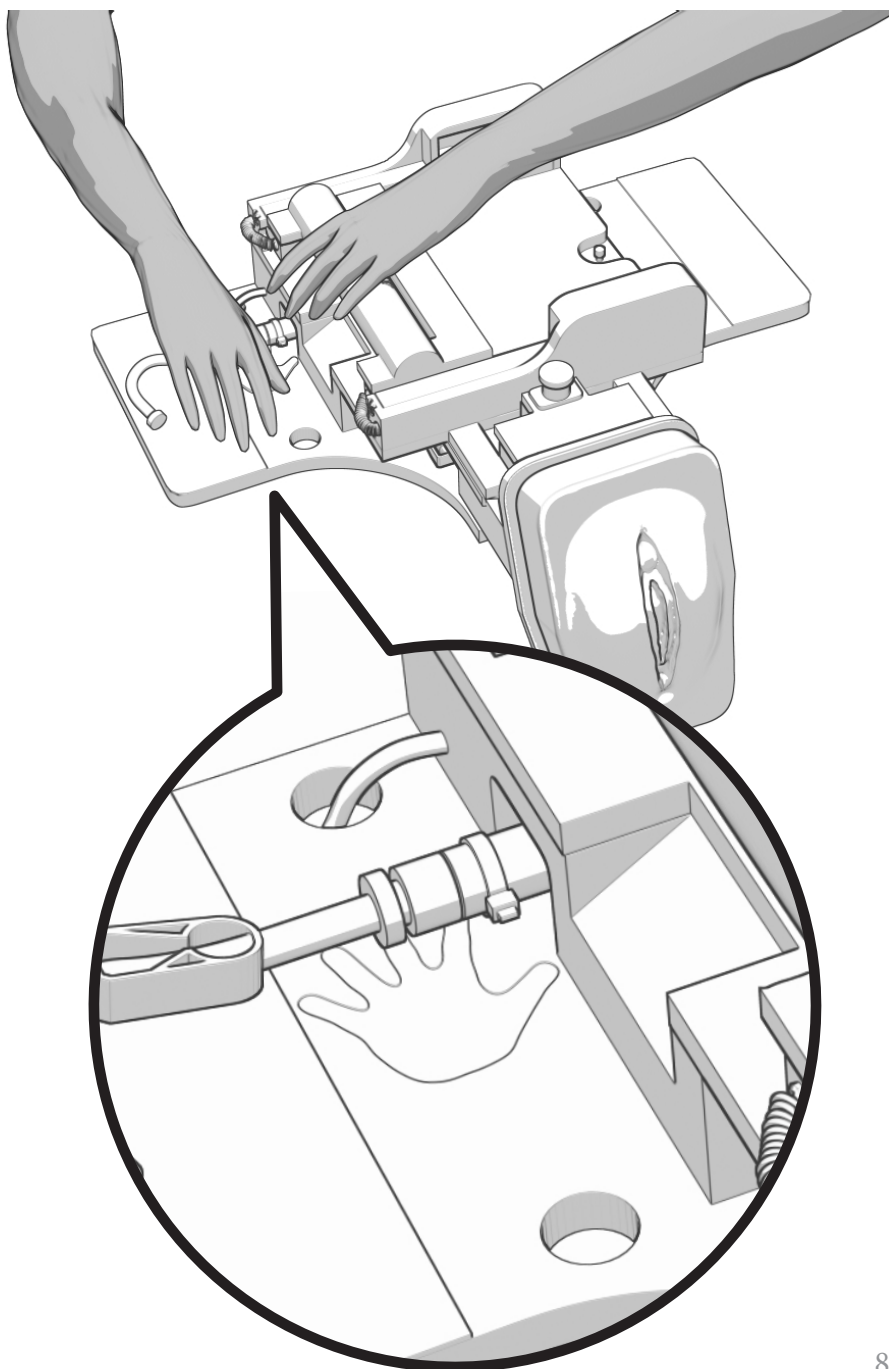

- C** Pull the handle all the way back, straight up, and release gently into the resting position.

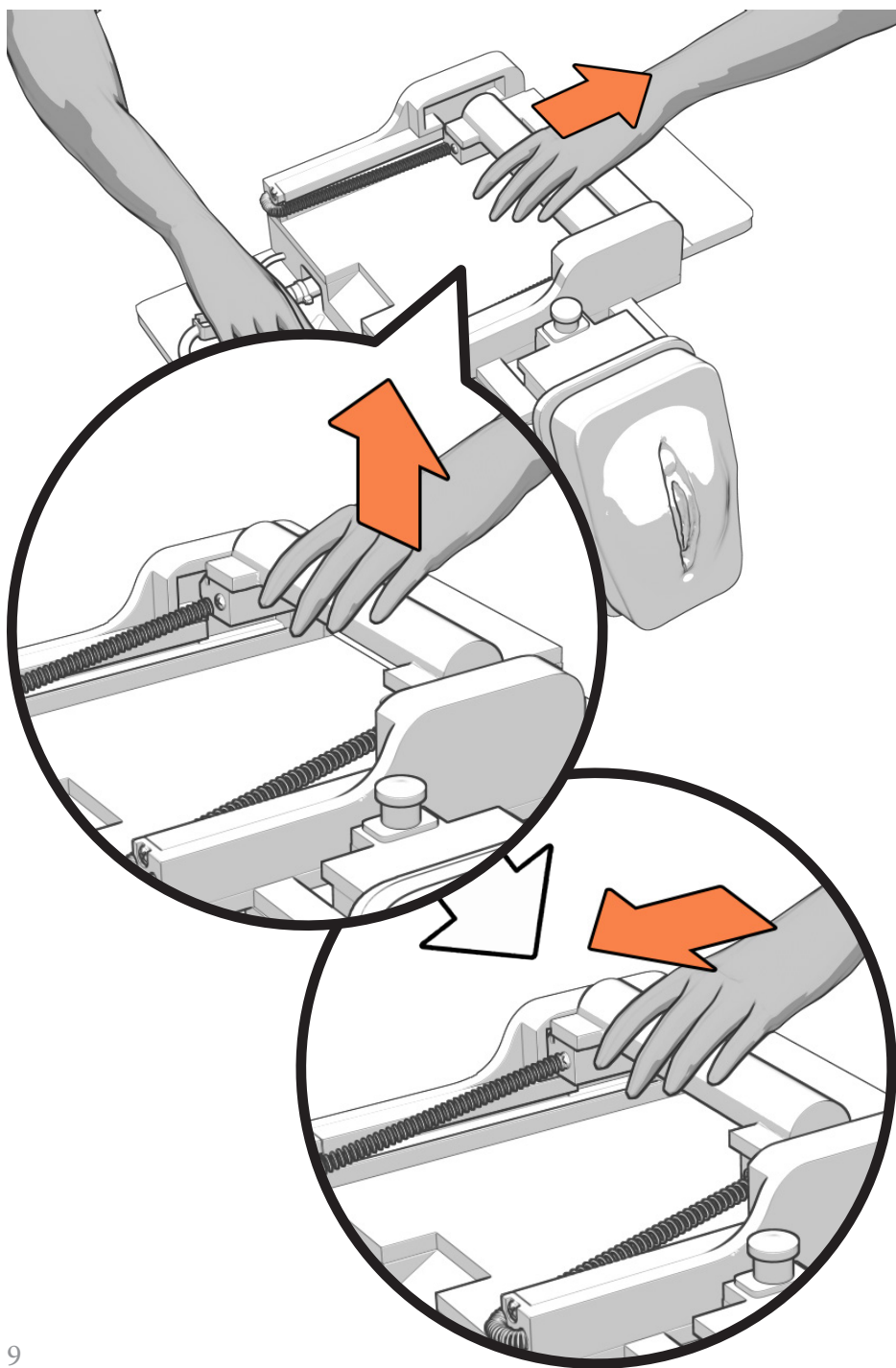

- d** Insert urine bag under white roller and handle.
Hook the urine bag on the small shoulder screw.

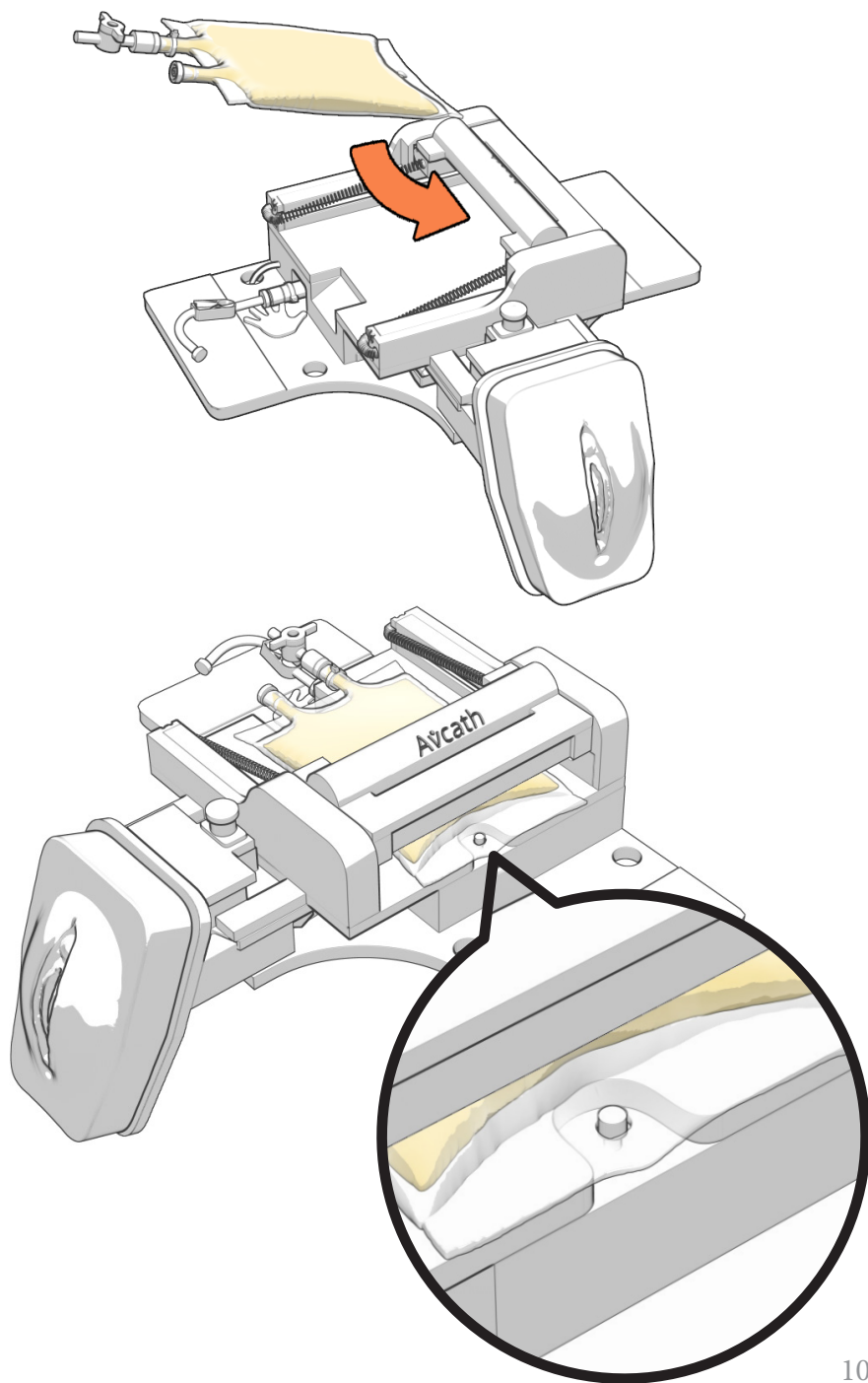

e Connect tubing to urine bag.

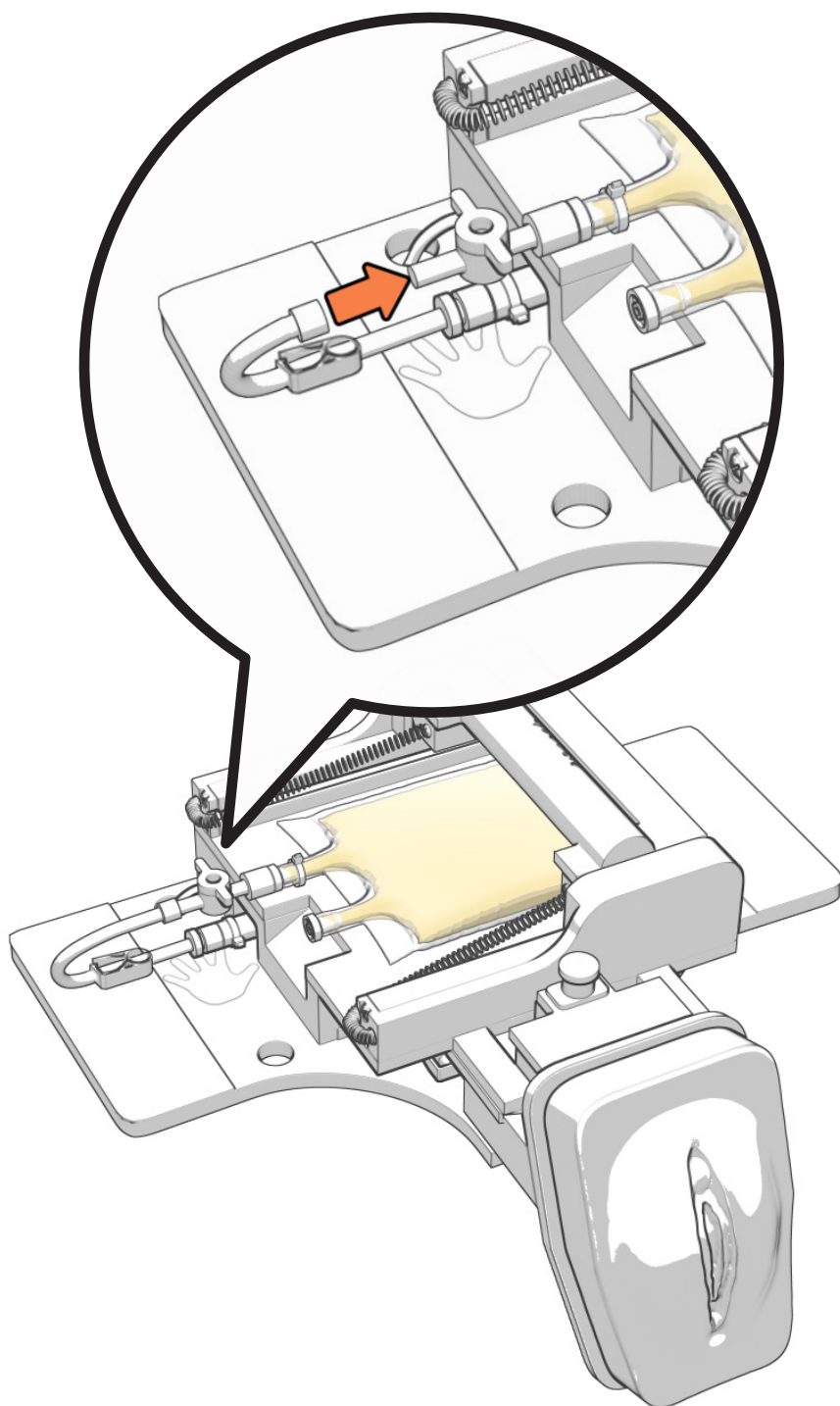

f

Put one hand on the engraved hand, and the other on the handle. Pull straight back, push down, and gently release the handle into the rail.

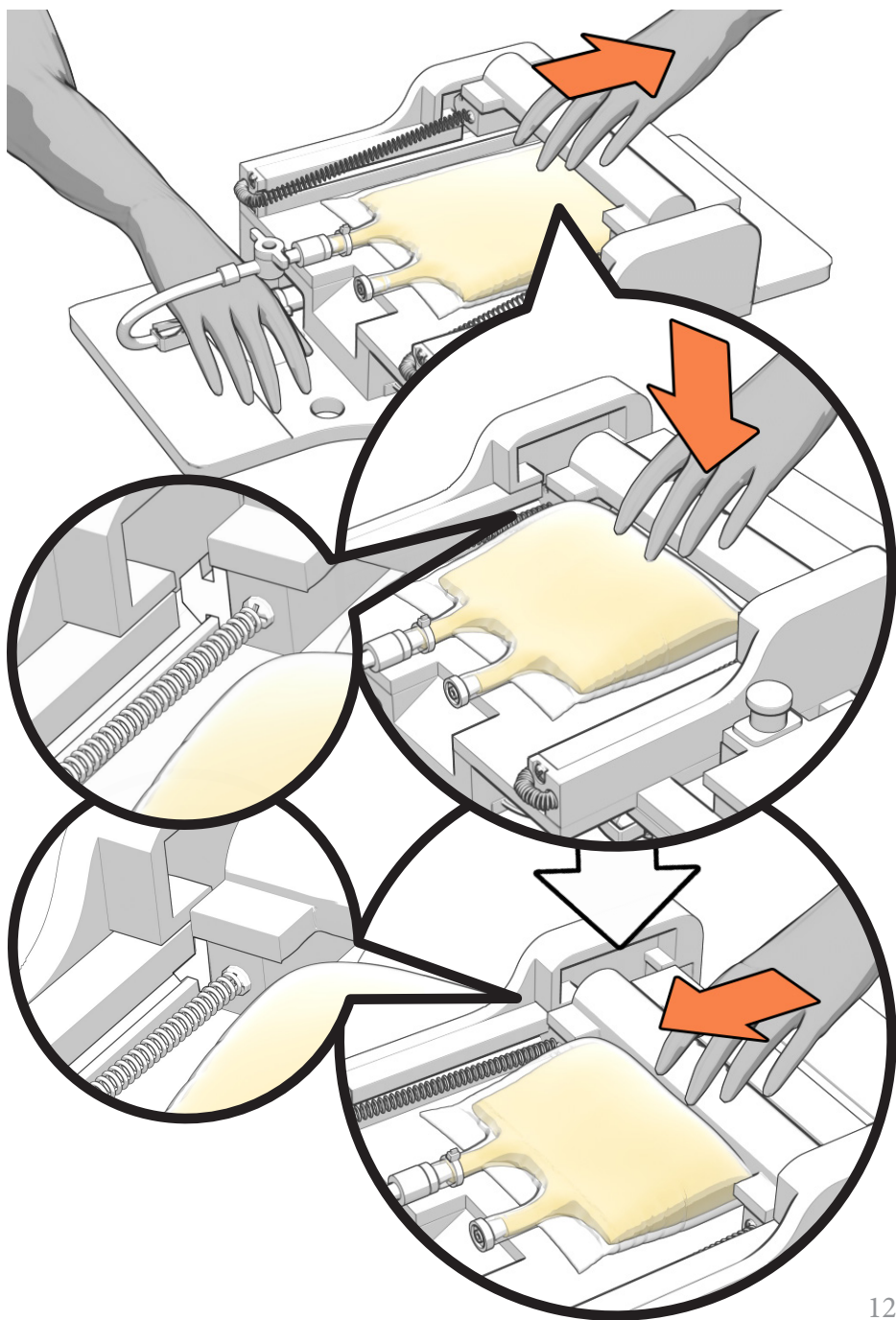



Open stopcock on urine bag.

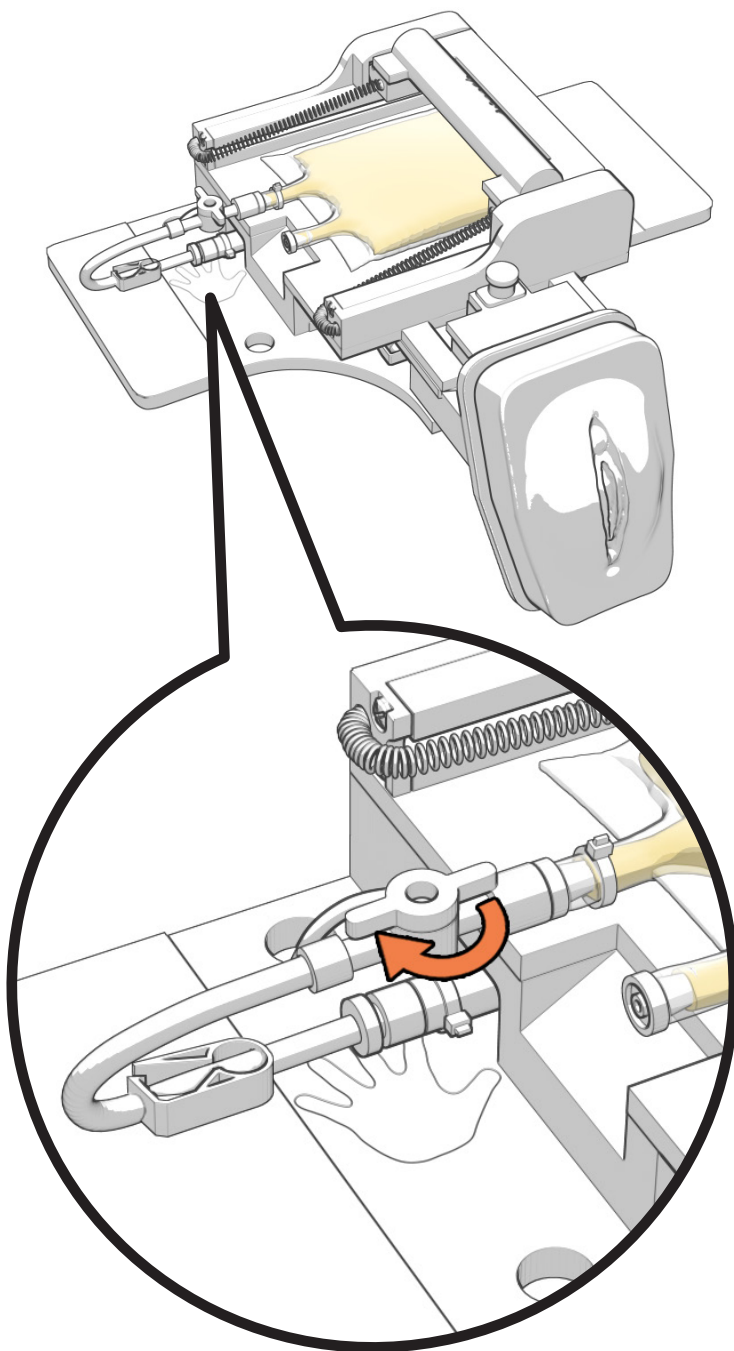

3 Put belly plate on device.

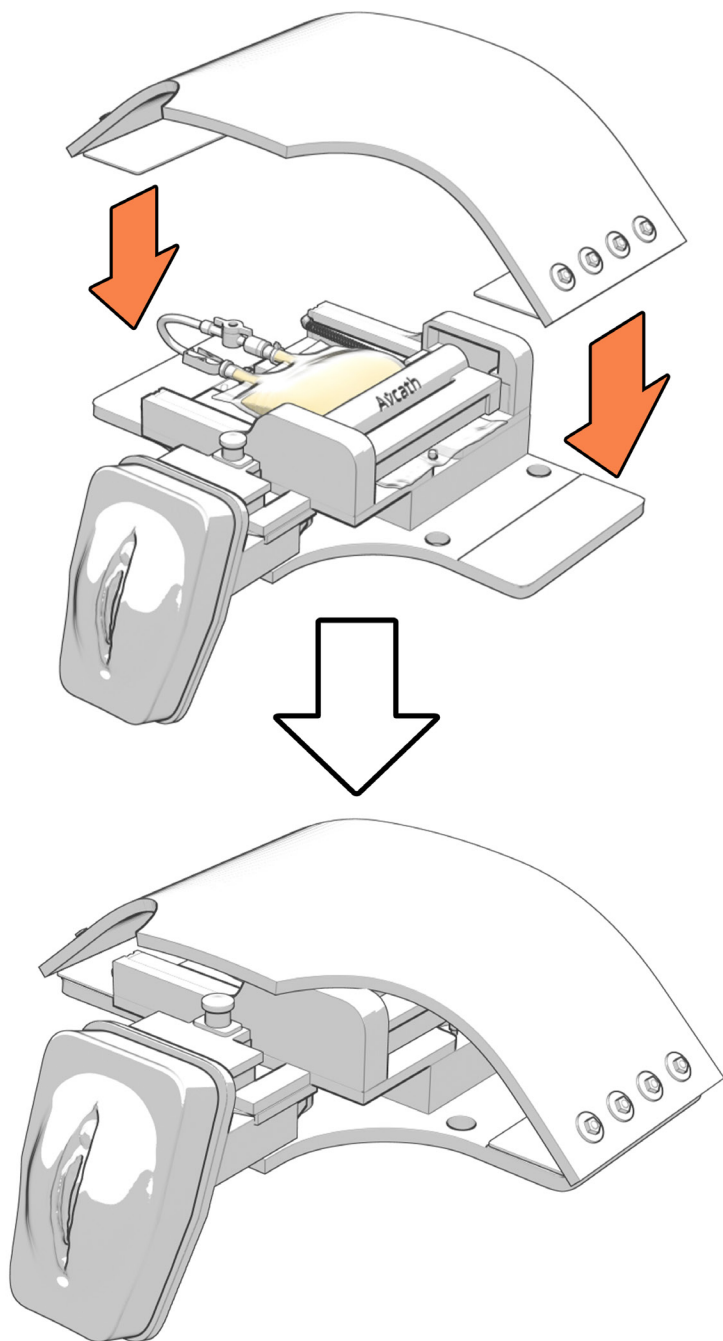

4 Insert mineral oil into device.

a Put tubing on mineral oil dispenser.

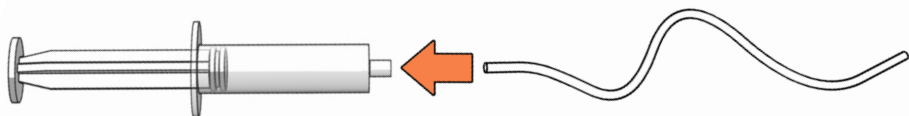

b Coat outside of tubing with mineral oil or lubricant.

c Insert into urethra, whenever the tubing gets stuck, inject mineral oil until tubing can move forward easily.

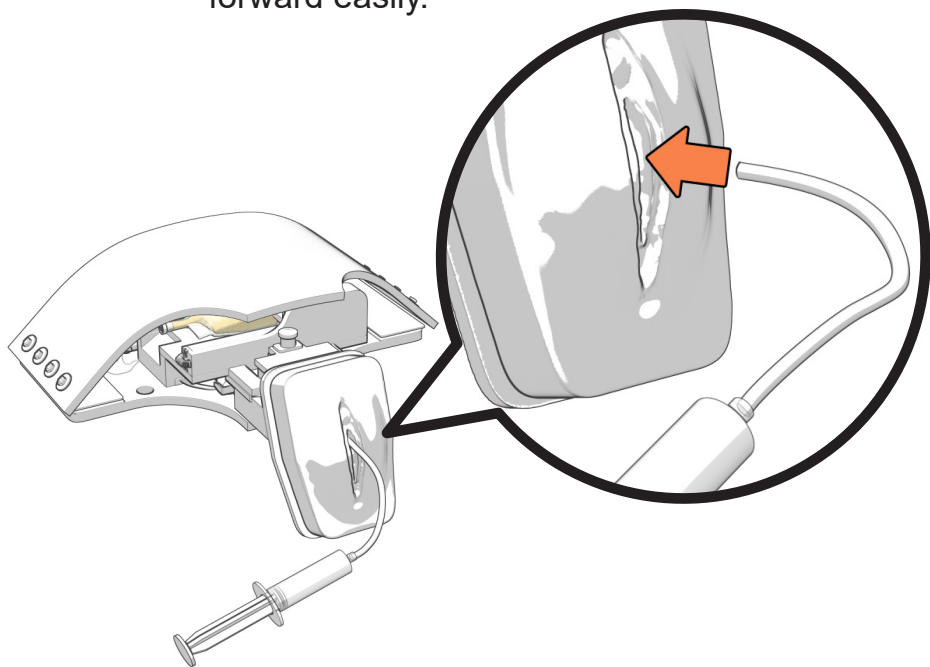

i For male genitalia, it should take about 1ml of mineral oil total to coat the system.

ii For female genitalia, it should take about .5ml of mineral oil total to coat the system.

5 Turn on the device (on/off on back of device)

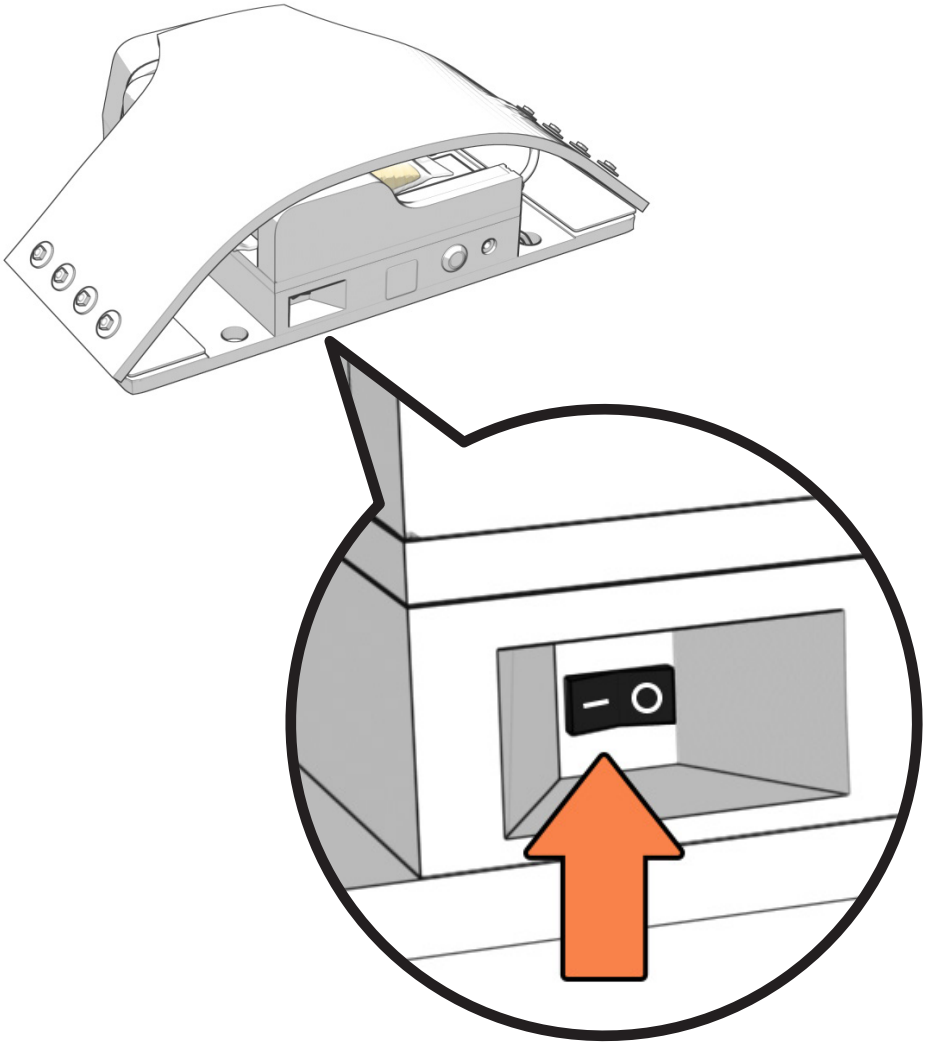

6 Prime the system.

- a** Before starting with your learners, turn the system on and put a catheter into the urethra. This checks that you (1) have enough mineral oil and (2) that there is urine throughout the system, so that the first time the learner goes to catheterize the patient there is no delay.

7 Put device on simulated participant (SP)

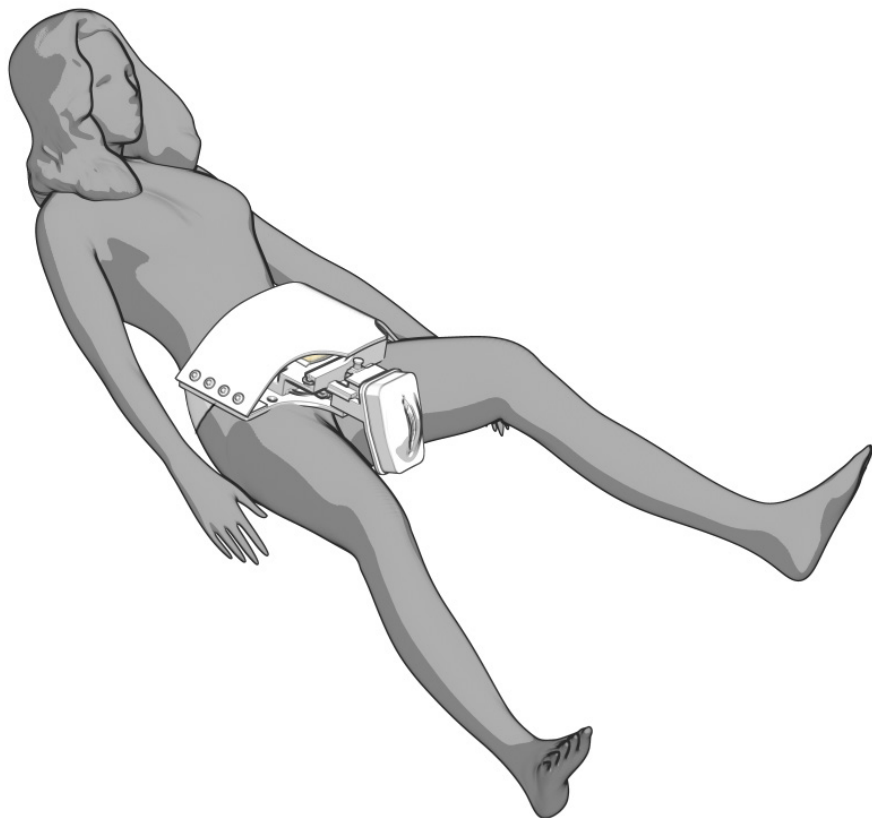

- a** Make sure SP is wearing tights or compression shorts and a t-shirt underneath the device.
- b** Buckle the device to the SP's preferred tightness.
- c** Check to make sure that the device is laying flat on the SP, if the device is at an angle it could leak out the urethra during catheterization.

PUTTING AWAY

- 1 Remove belly flap.
- 2 Close stopcock to urine and disconnect tubing from urine bag.

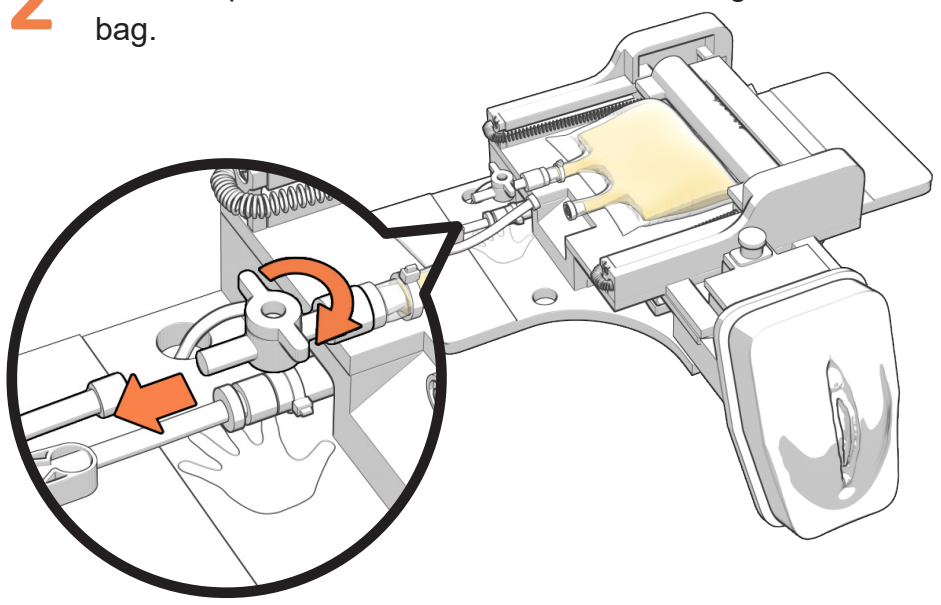

- 3 Remove urine bag

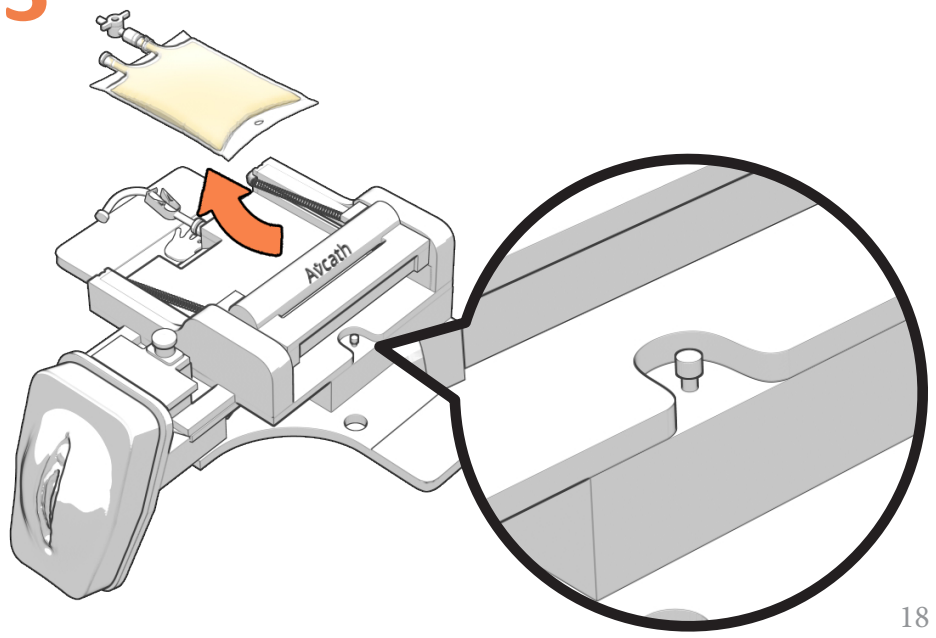

4 Empty the device of fluids.

- a** If you used distilled water and yellow food dye for urine, you just need to empty the device at the end of the day. If you used anything organic in your urine, flush the system with alcohol/distilled water solution first.
- b** Turn device on its side.
- c** Hold over a sink or bucket.
- d** Press the release button (blue button on back of device) until the urine is emptied out of the device.

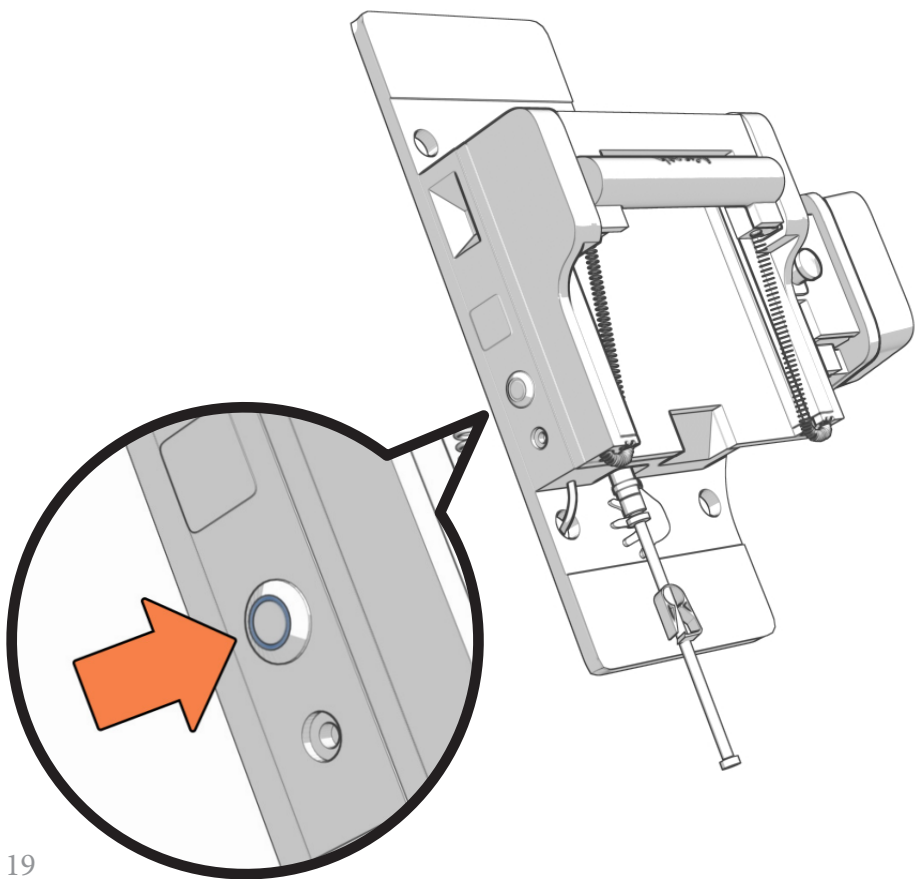

5 Remove genitalia

- a** Pull up the Spring Plunger and twist it slightly to the right, and gently let go to lock the pin.

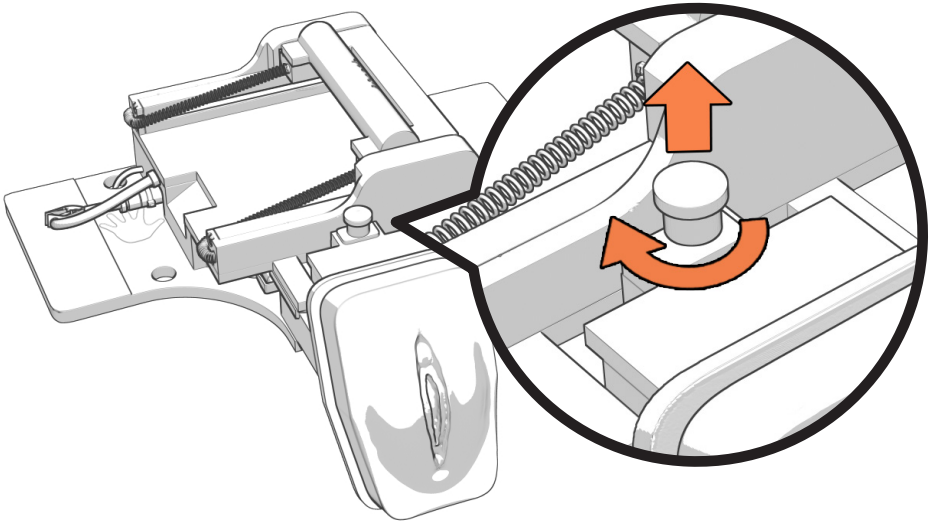

- b** Flip the entire device over.

- c** Place the thumb and pointer finger on the large metal fitting coming from the yellow compartment. Push down and hold the little metal switch.

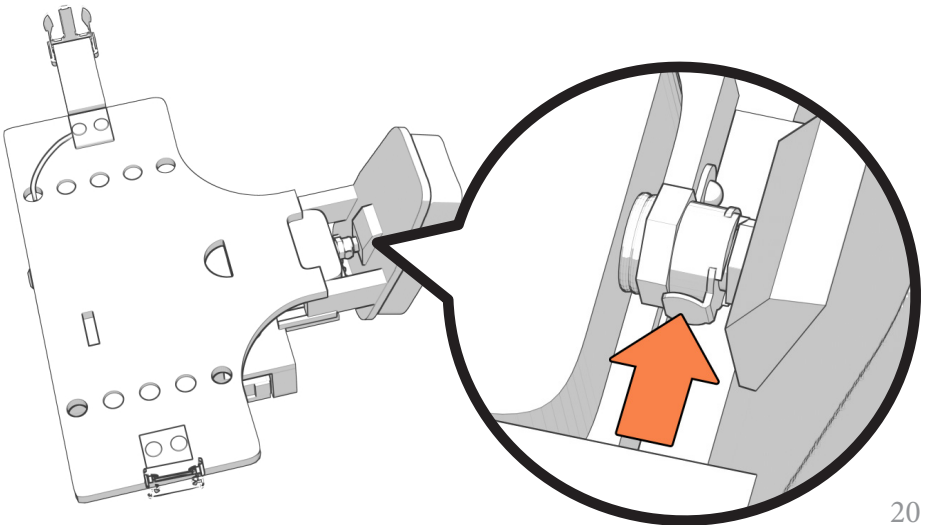

- d** While holding down the metal switch with one hand, use the other hand to pull the genitalia straight back until it is completely off the guide rail system.

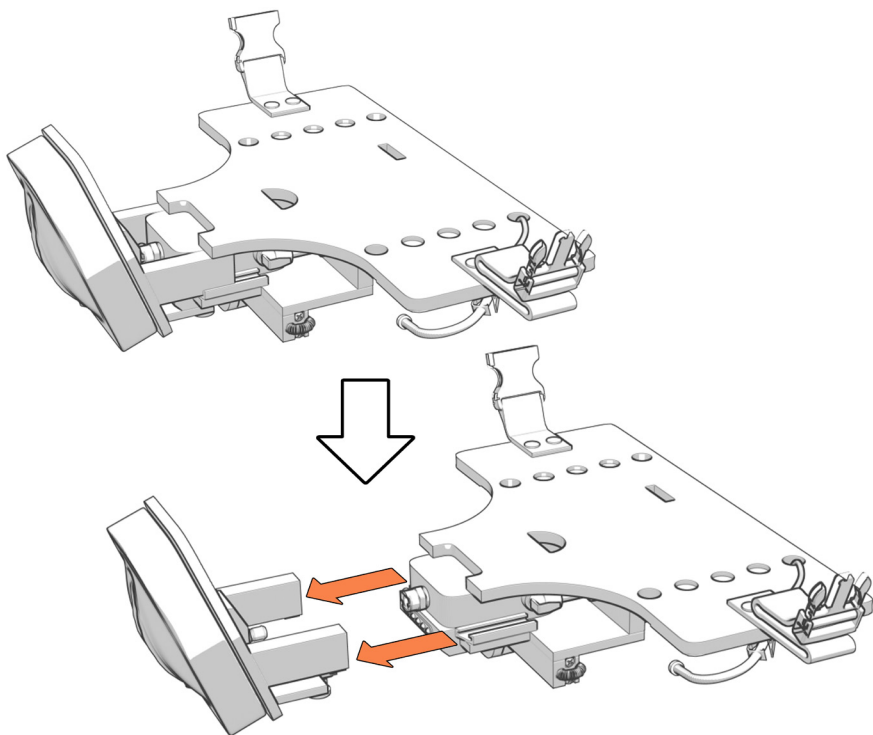

- e** Turn the device back over. Gently lift slightly up on the spring plunger and twist slightly to the right to let the head to all the way down.

- f** Store with belly plate flaps flat.

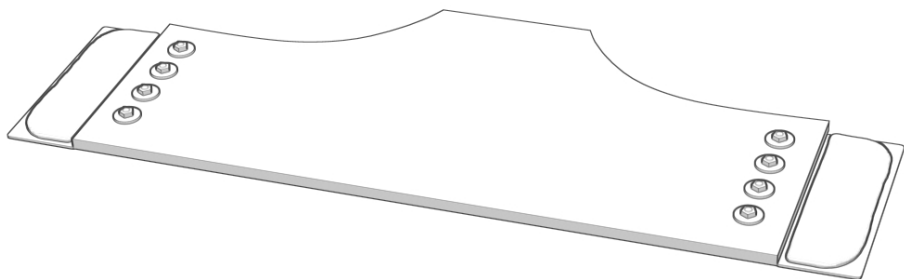

TYPES OF CATHETERS

The following catheters have been tested and are confirmed to work with the Avcath:

- Bard Lubri-Sil – 14 Fr, 5cc Balloon, Silicone Coated
 - We recommend this catheter for best results!
- Bardex I.C. – 14 Fr, 5 cc Balloon
- Medline Foley Catheter Silicone Elastomer Coated (Latex), 14 Fr, 5-10cc
- Medline Urethral Self Catheter, Male, 14 Fr
- Bard Lubricath – 12 Fr
- Dynarex 14 fr latex catheter

Types of Catheters that do NOT work with Avcath:

- Bard Lubricath – 14 Fr

If you would like us to test another type of catheter, please email us and let us know!

CARE AND MAINTENANCE

TO CLEAN EXTERIOR

1 Use a damp lint-free cloth to clean off the silicone abdomen plate. Once dry, dust with baby powder or cornstarch to remove tackiness. Add cocoa powder to the cornstarch if you have a dark skin tone Avcath.

2 If you are experiencing leaking around the catheter or under the genitalia when catheterizing, replace the finger cots.

a Using the wrench tool (provided in the Avcath disposable kit) unscrew the large metal fitting in the yellow compartment.

b Peel the finger cots off the large metal fitting.

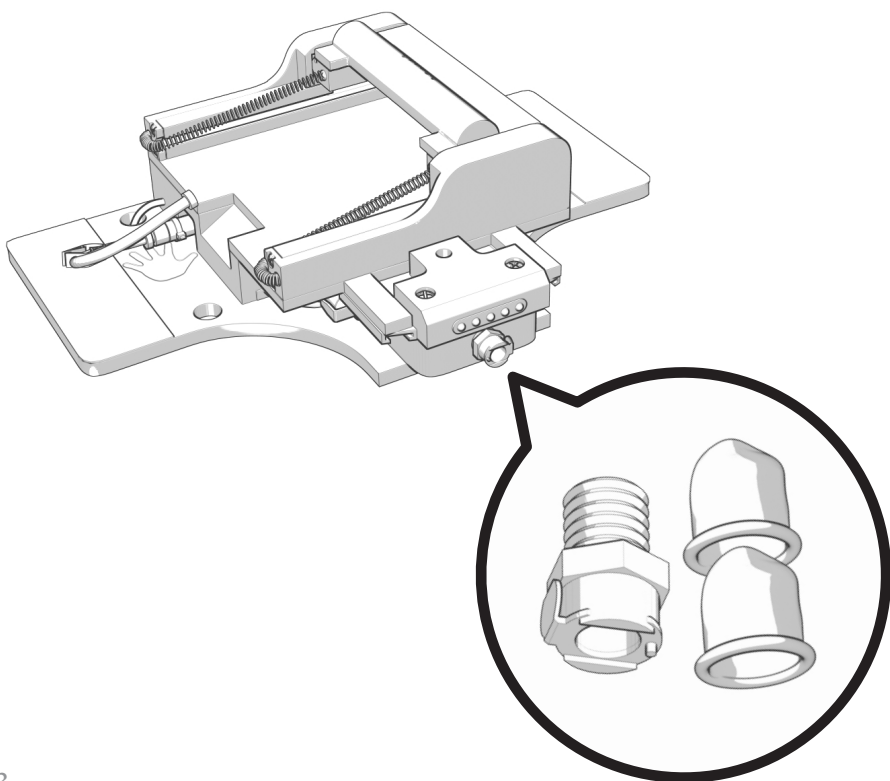

- C** Roll two new finger cots over the threaded end of the large metal fitting.

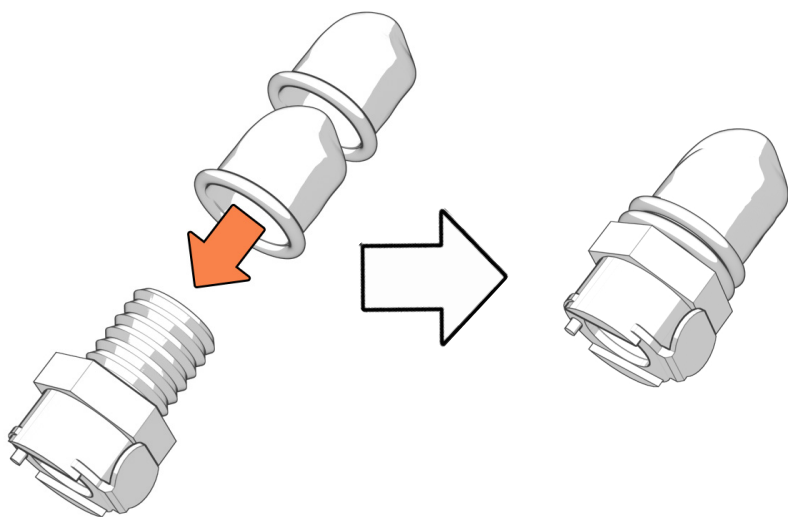

- d** Insert the spear tool (provided in the Avcath disposable kit) through the metal fitting and into the center of the finger cots to create an indentation in the finger cots.

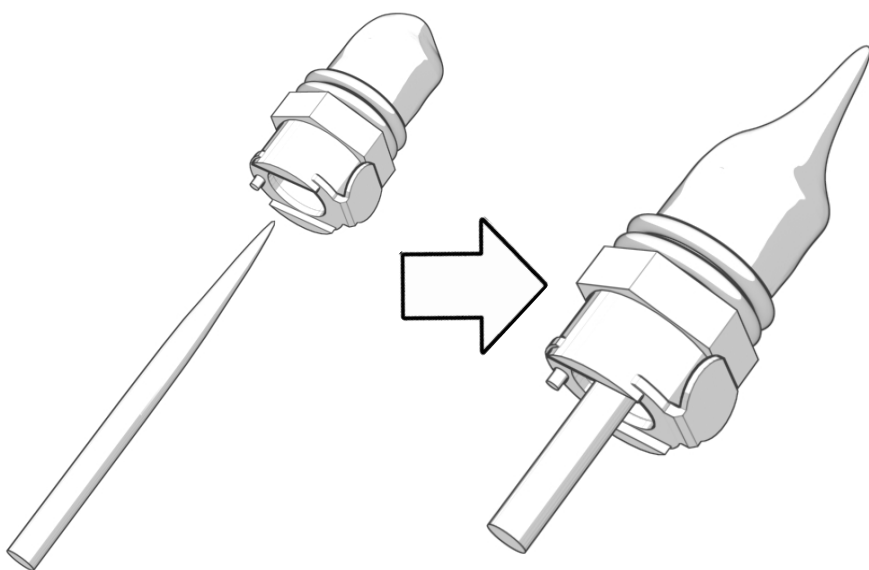

- e** Snip off the tip of the indentation to create a small hole in the finger cots

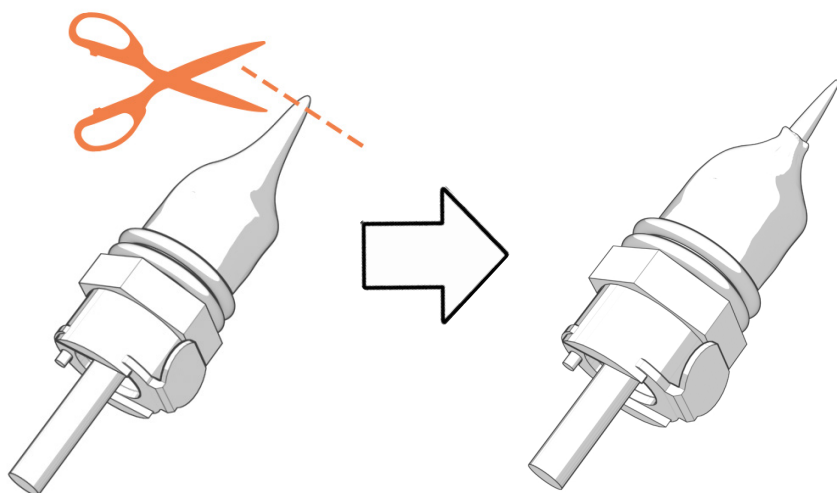

- f** Slowly progress the spear tool further into the cut hole to increase the size of the hole to match the diameter of the spear tool.

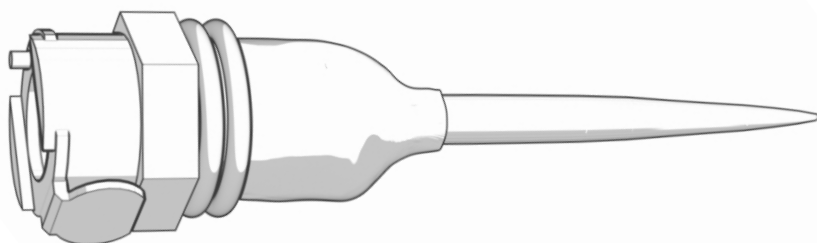

- g** Remove the spear tool and insert an indwelling catheter (provided in the Avcath disposable kit), so that the ballooned tip is in the middle of the cut in your finger cots

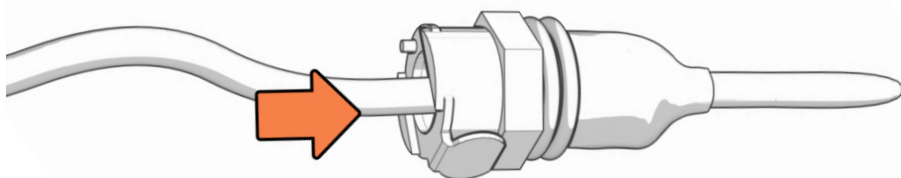

h Lubricate the sides of the finger cots with mineral oil or hand sanitizer

i While keeping the catheter in the finger cots, screw the large metal fitting back into the yellow compartment until tight *make sure the little metal switch is facing to the left or right when the metal fitting is back in place

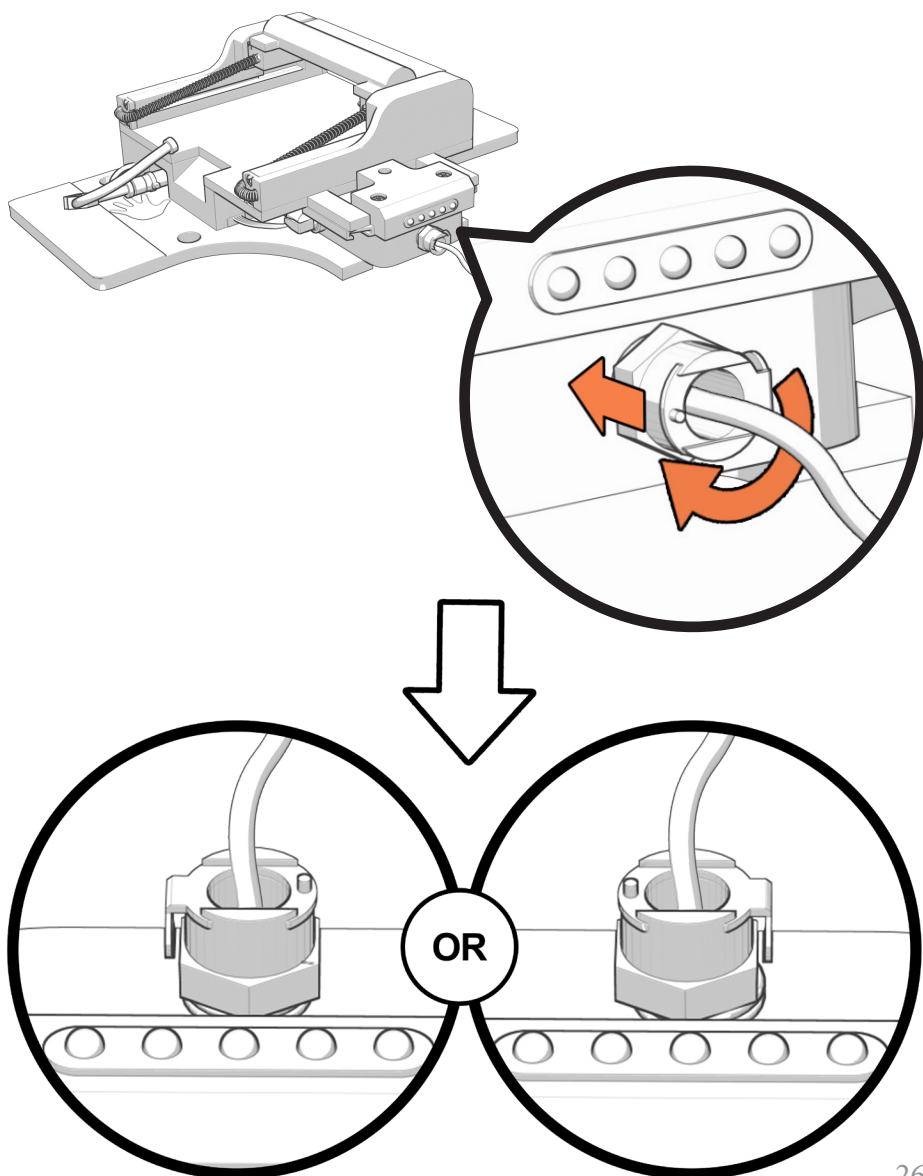

- j Remove the catheter from the device, lubricate it, then slowly insert and remove the catheter a few times to shape the hole in the finger cot to the size of the catheter

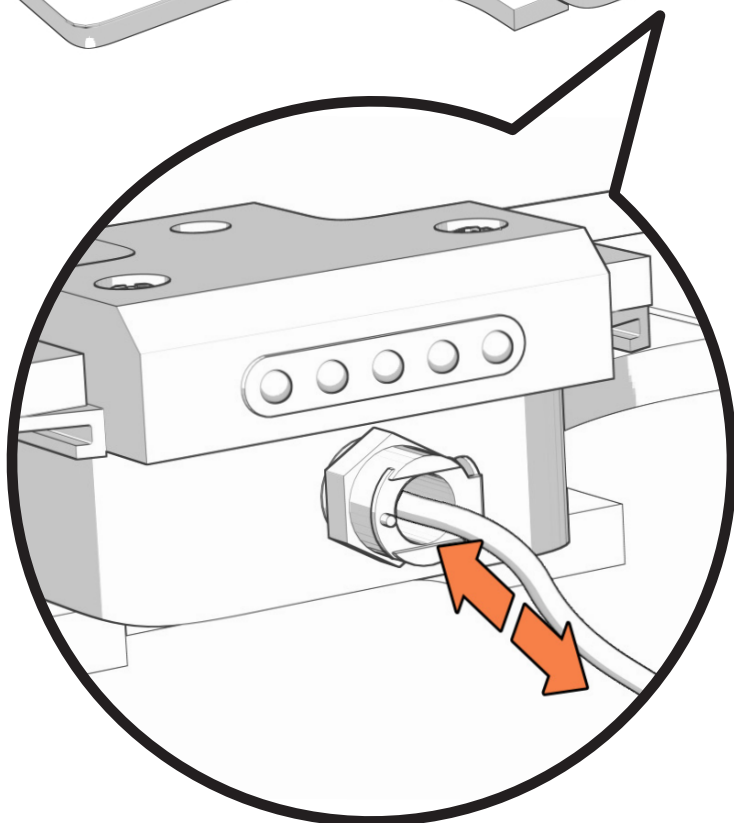
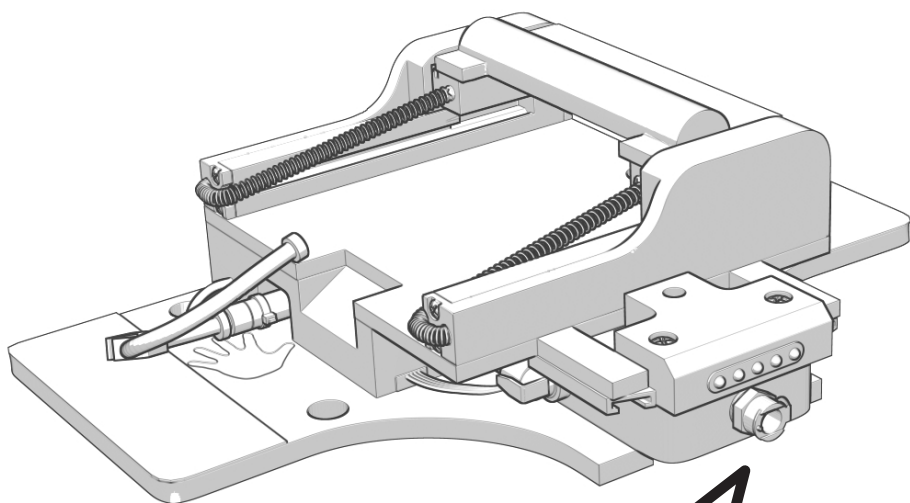



AVCATH BATTERY SAFETY GUIDELINES



The Avcath contains a rechargeable 12V Lithium Ion Polymer Battery that could cause injury if mishandled. Follow the proper handling procedures for the Avcath and the Avcath charger:

- Do not charge the Avcath with any other charger than the one that came with it
 - Call Avkin for a replacement if you need a new charger
- Do not charge or use unattended
- When charging, keep away any flammable or conductive materials (ex: textiles, paper, metal, etc.)
- Do not disassemble the Avcath battery
- Do not puncture the Avcath battery
- Do not immerse the Avcath in water or other liquids
- Do not expose the Avcath to:
 - Extremely cold temperatures (below freezing, 32 deg F)
 - Extremely hot temperatures (above 130 deg F)
 - Direct sunlight
 - Hot vehicles
- Do not expose the Avcath to mechanical impact (ex: throwing, dropping, etc.)
- Do not use the Avcath if its battery is damaged
 - Call Avkin for support if needed
- Store the Avcath in a cool, dry place
- Keep the Avcath away from children - it is not a toy
- Refer to FAA guidelines for airplane transportation of devices with installed lithium batteries:
 - Turn the Avcath completely off (power switch on the side)
 - It is off when the Red/Green/Blue light is off
 - Protect it from accidental power-on
 - Pack it to cushion it from damage

Avcath is provided by:



www.avkin.com