



USER MANUAL

Customer Assistance

302-562-2110

Technical Support

302-562-2040

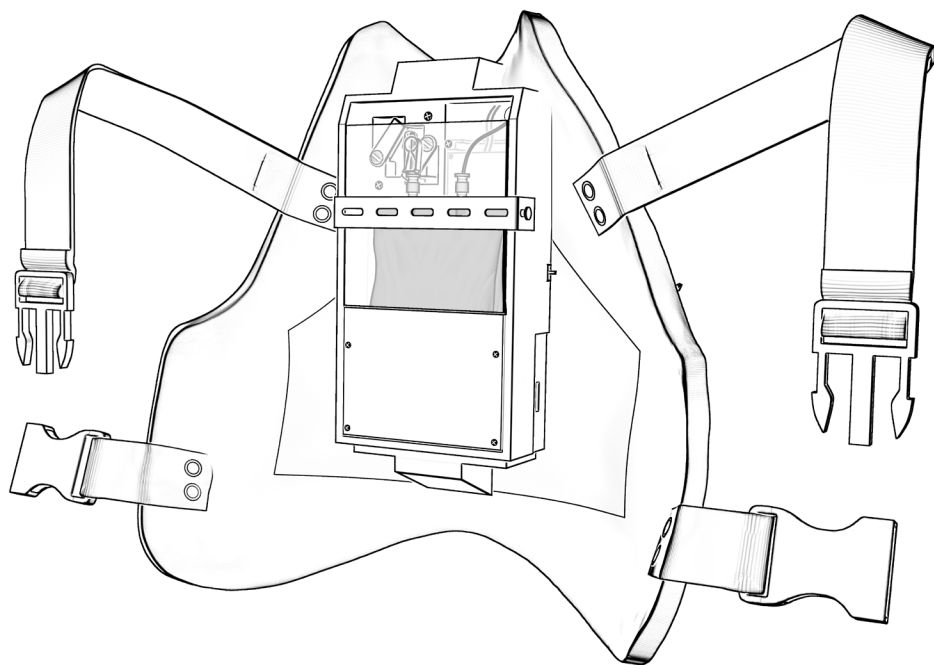
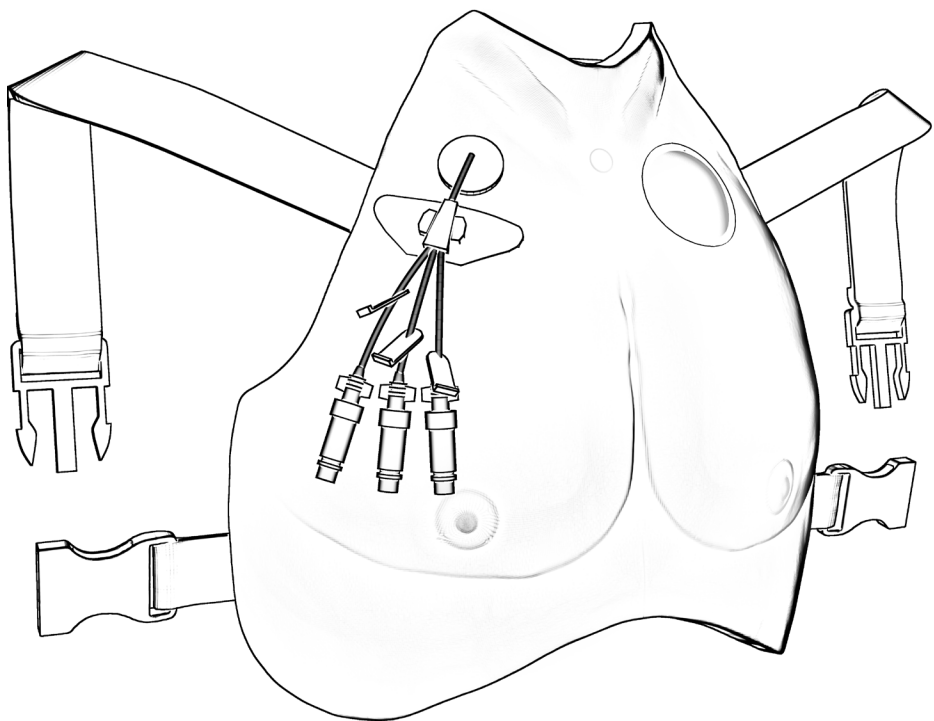

Welcome to your Avline!



Heart Sounds*- five heart sound locations can be controlled through the Avkin App

Simulated Blood- antimicrobial blood for blood draw and flushing

Sensory Feedback- Standardized patients are cued through a light vibration on the shoulder to provide a patient response when pressure is applied around the central line or to the port-a-cath. Learners receive real time feedback about their care

*Heart sounds provided by our partner, eMurmur 

What's Included

- ✓ Avline: wearable central line simulator for use with standardized patients.
- ✓ 7 fr Central Venous Catheter
- ✓ Simulated Biopatch
- ✓ Statlock
- ✓ Set of three port-a-caths : short, long, tilted
- ✓ Blood bags (2, one located in device)
- ✓ Replacement port-a-cath skin
- ✓ Funnel
- ✓ Micro USB charger

Getting Started

Watch the instructional video on the customer portal and USB.

- 1** Download the “Avkin” App on your Apple or Android device.



- 2** The central line and port-a-cath features can be used at the same time on the Avline. Follow the instructions below to set up one or both of the features.

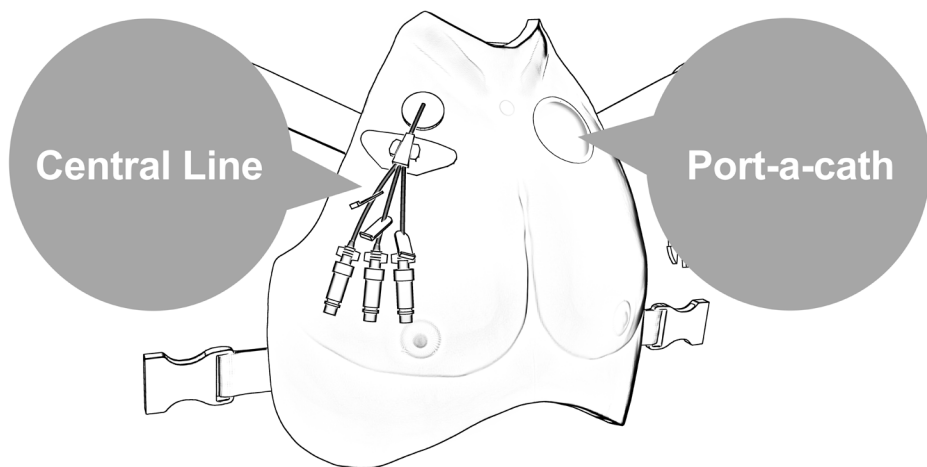

Central line

- 3** If the central line needs to be inserted into chest, poke central line through hole in chest and align with hole in chestplate assembly to feed through to back of the device.

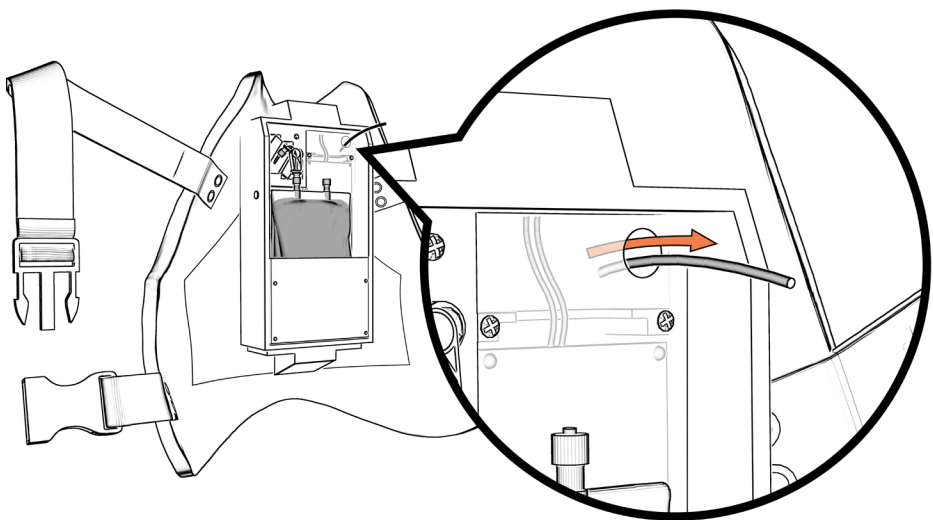
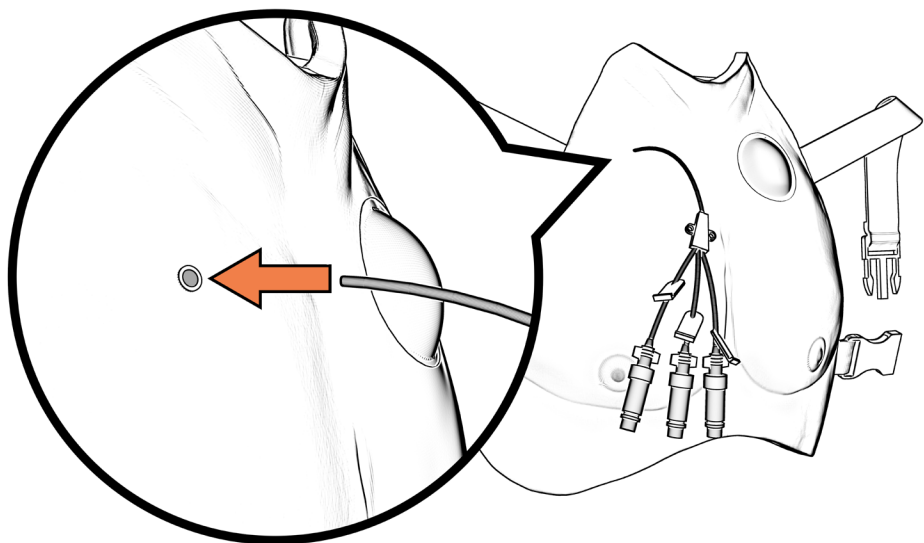

- 4** Ensure there is a connector on the central line located inside the chestplate.

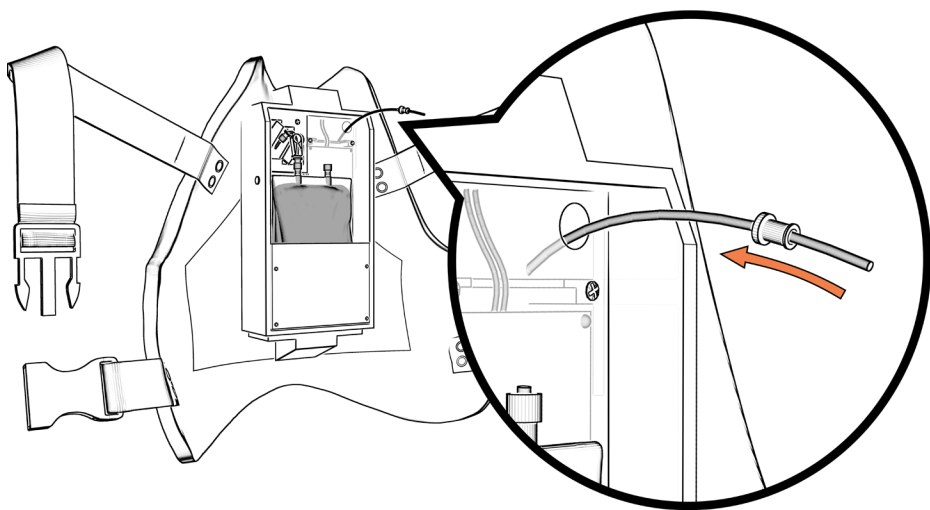

- 5** Remove cap from central line side of blood bag. Thread central line into blood bag until there is a little slack outside of the bag. Screw on cap that is on central line to blood bag.

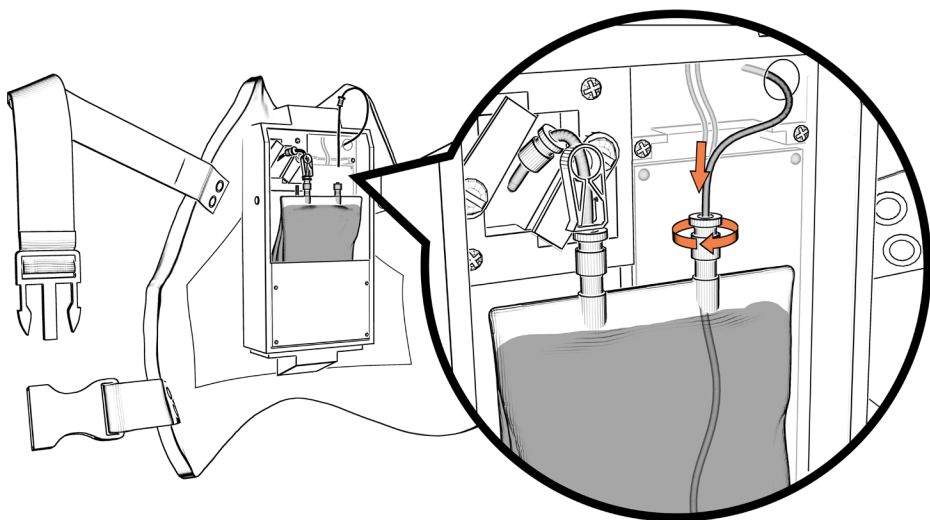

- 6** Using a syringe attached to the central line, pull blood out of the device to prime the system.

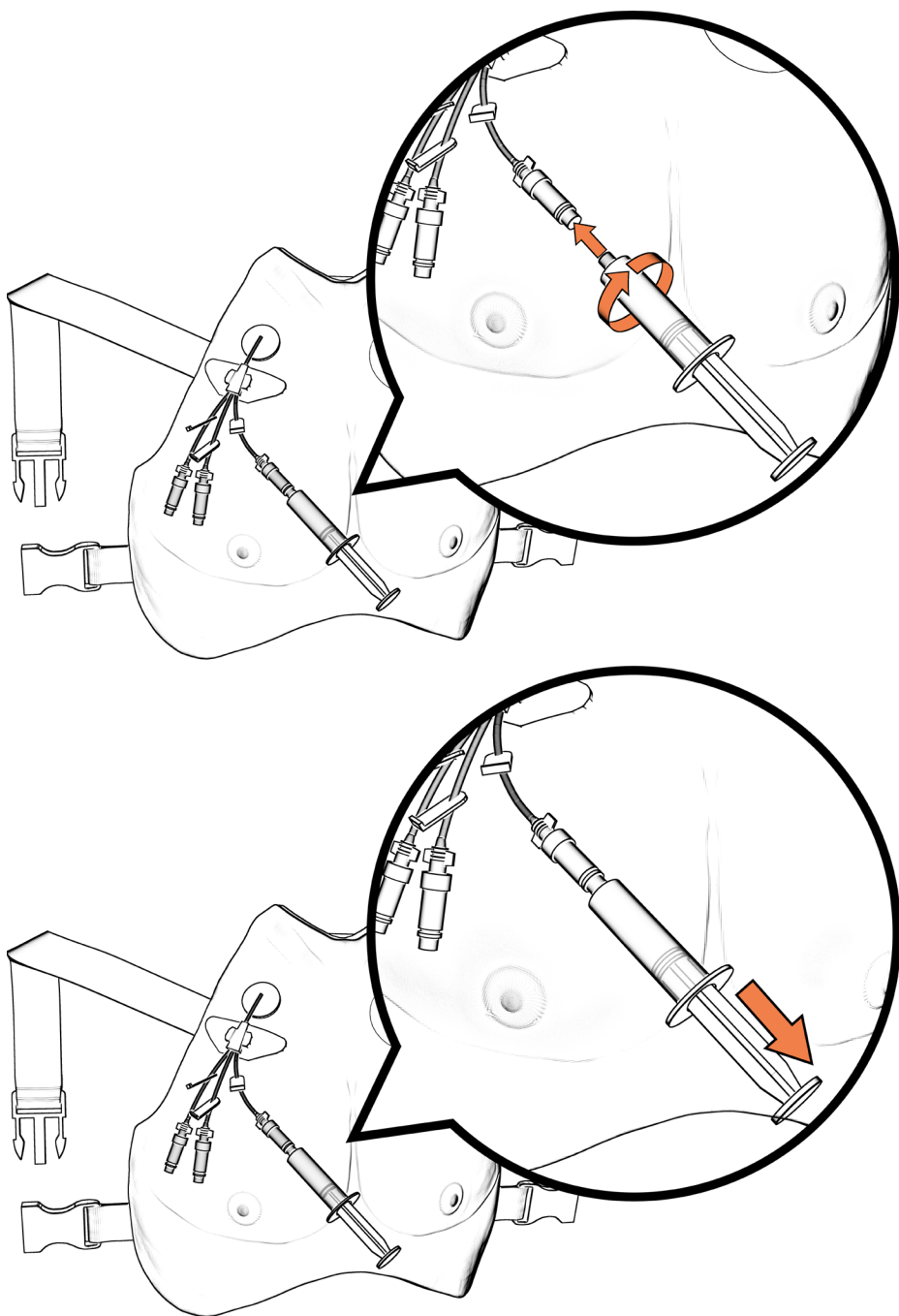

- 7** If not using port-a-cath, release the port-a-cath housing so it is not pushing port-a-cath into skin.

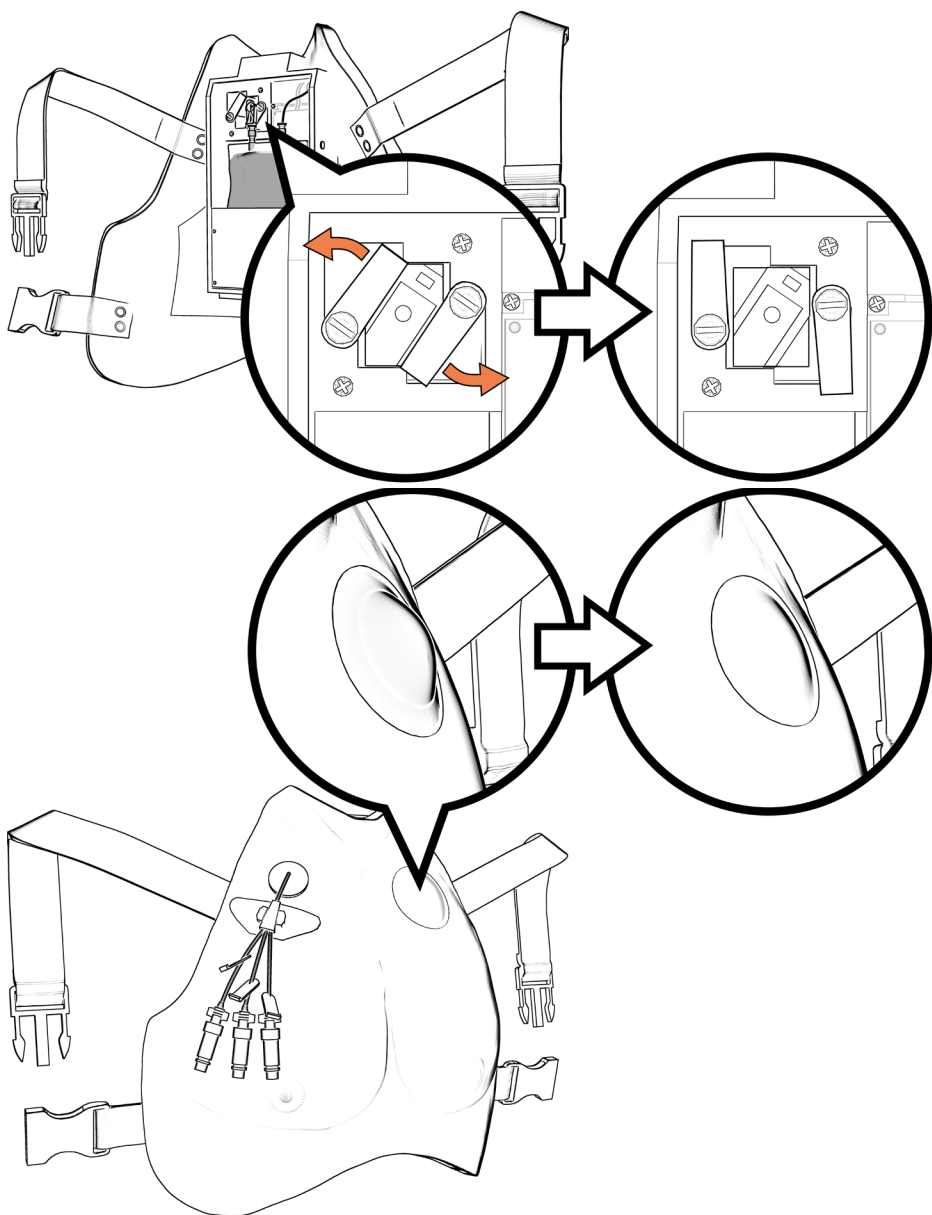

Port-a-cath

- 8** Connect barb on Port-a-cath to Port-a-cath tubing.
Connect tubing from blood bag to Port-a-cath tubing.
Release white clip.

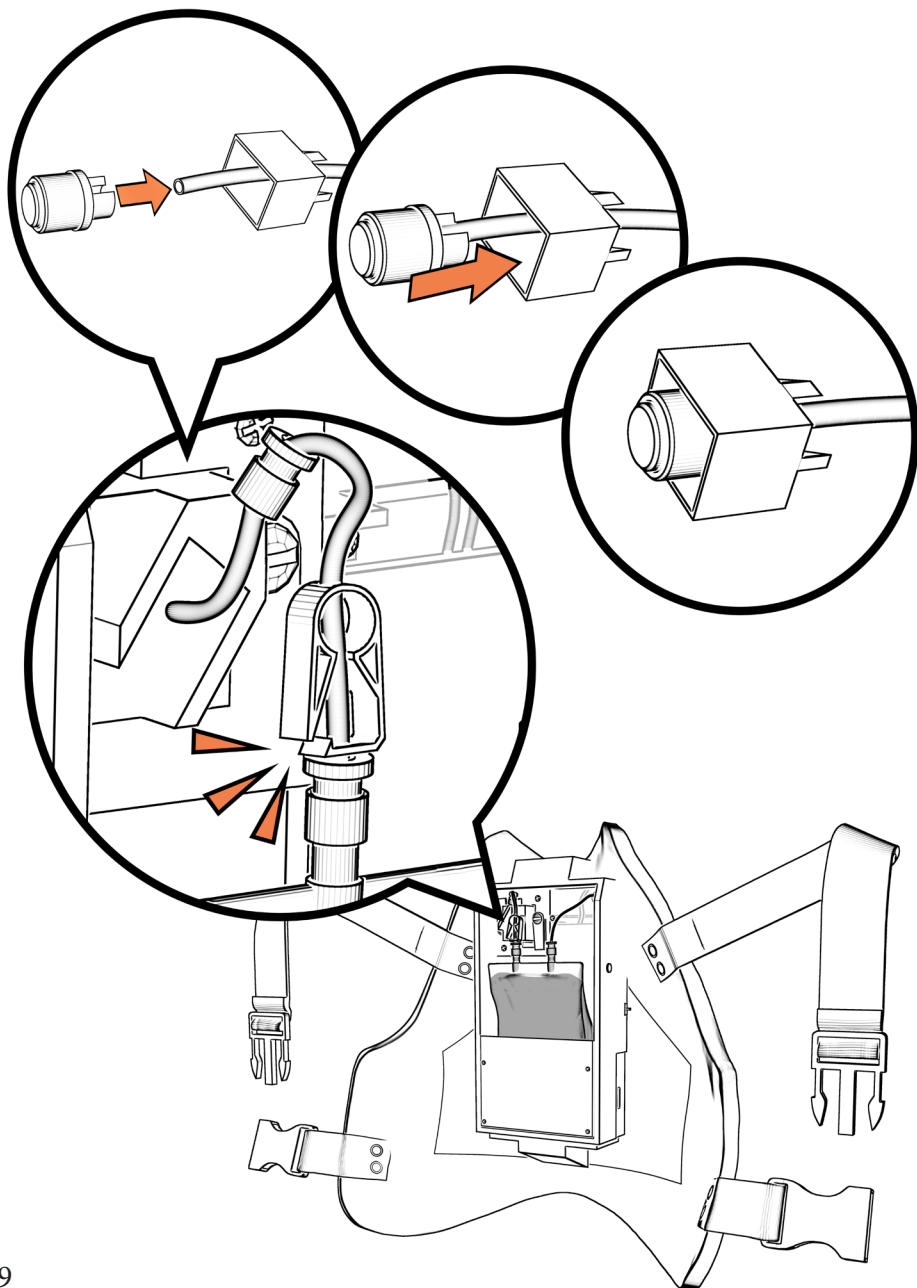

- 9** Make sure Port-a-cath housing is pushed into device and clamped down.

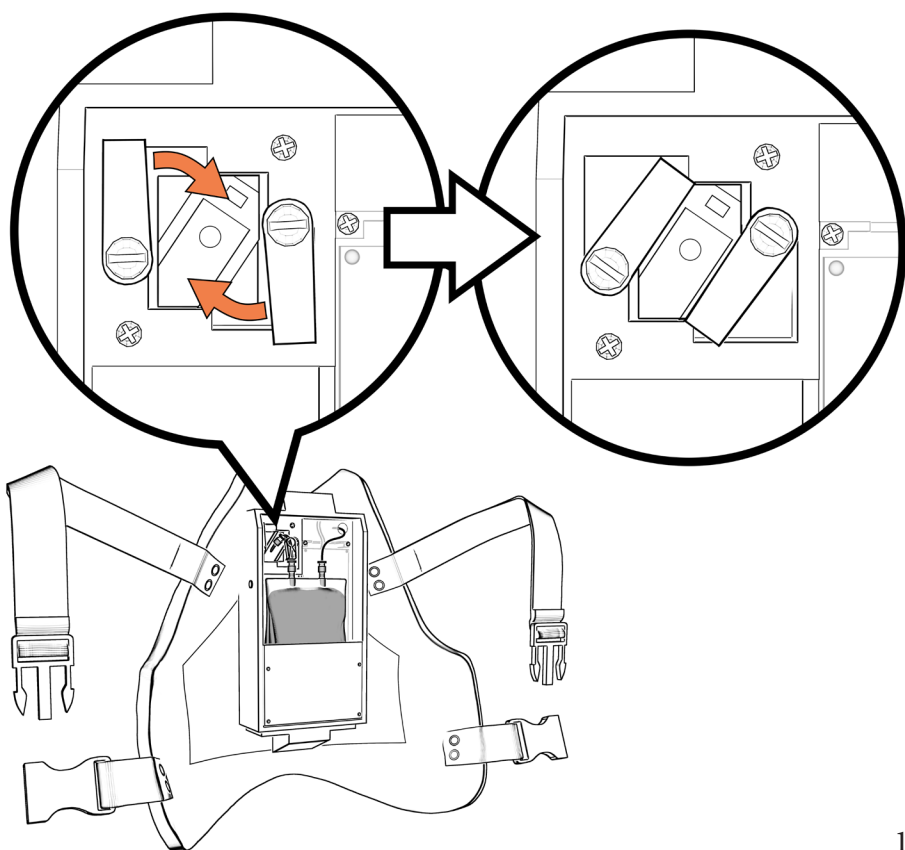
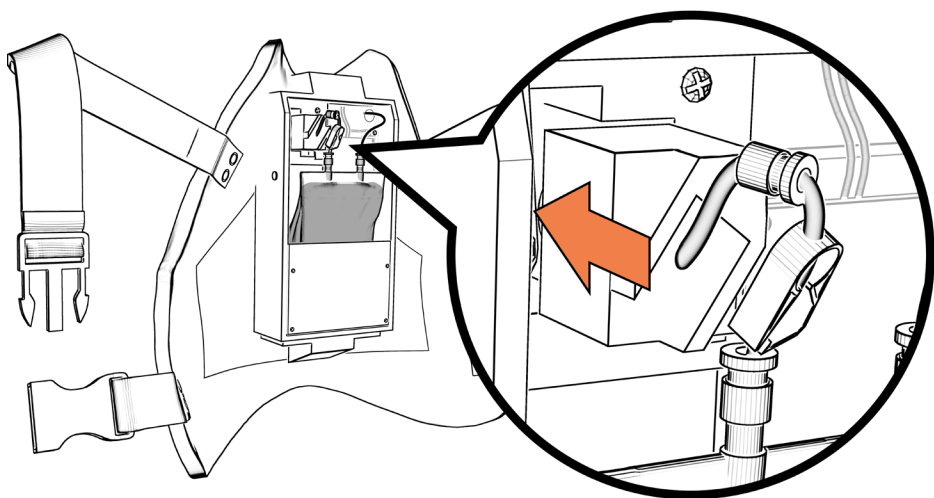

10 Attach electrical connection to Port-a-cath housing.

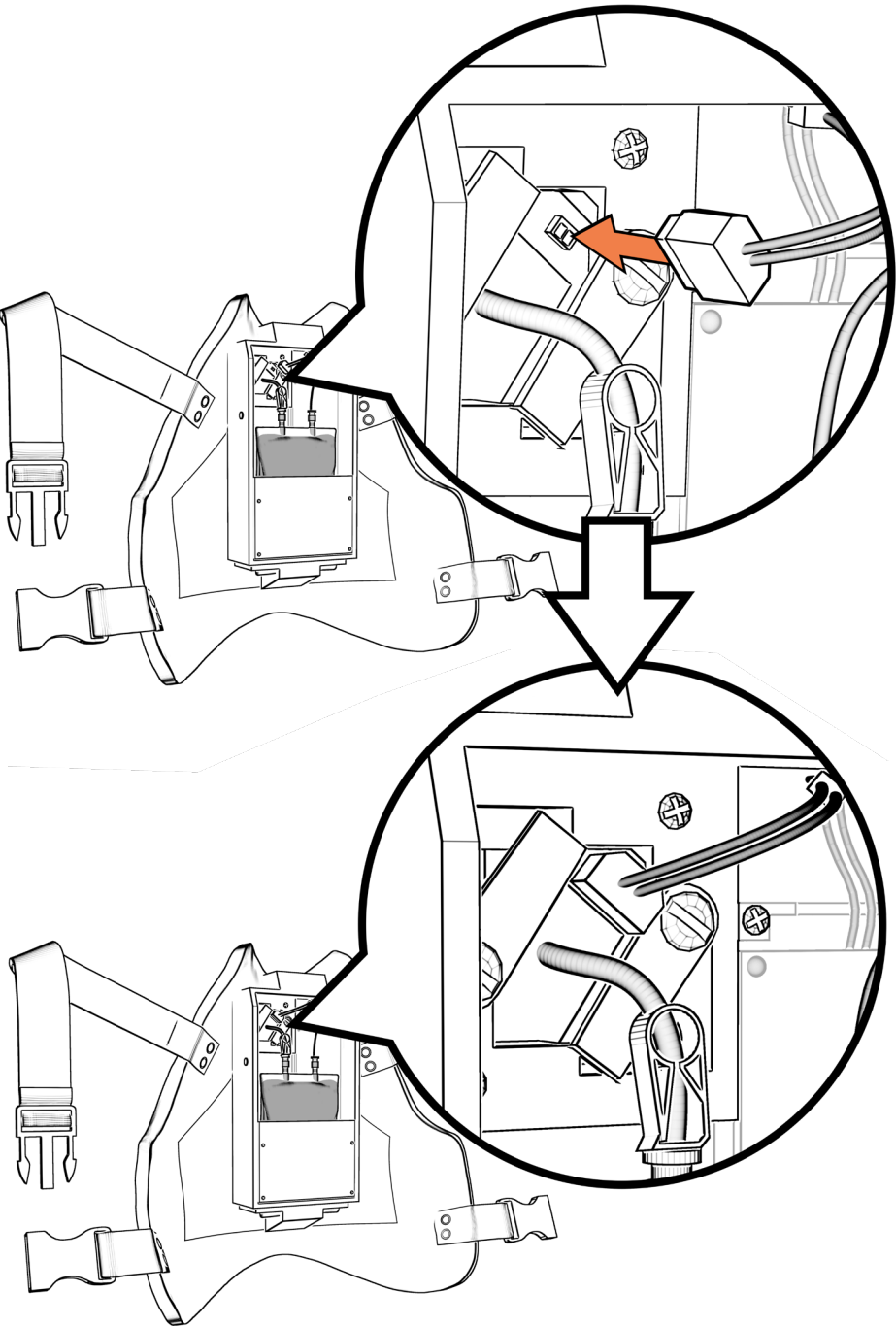

- 11** Using a syringe attached to a huber needle, pull 10ml of blood out of the device, then push 5ml of blood back into the device to prime.

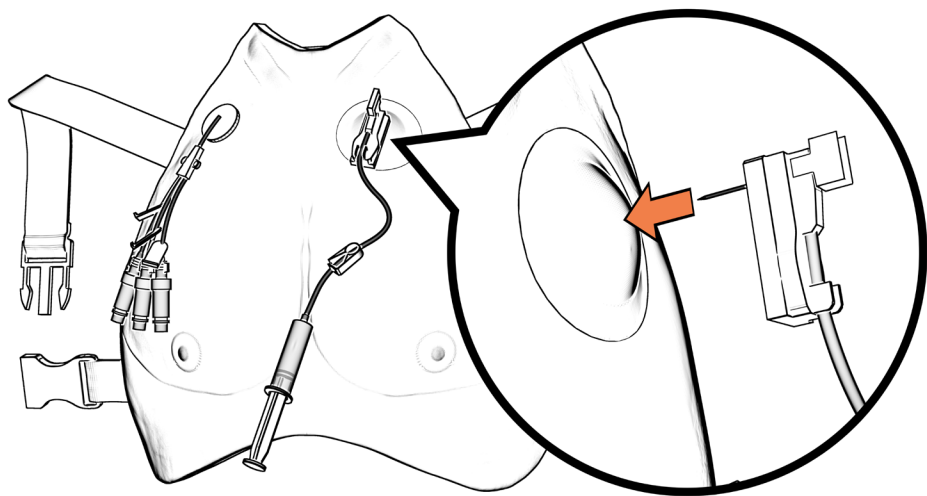

- 12** If you are not using the central line, remove the central line from the blood bag (cap the bag), remove the cap from the central line, and remove the central line from the device.

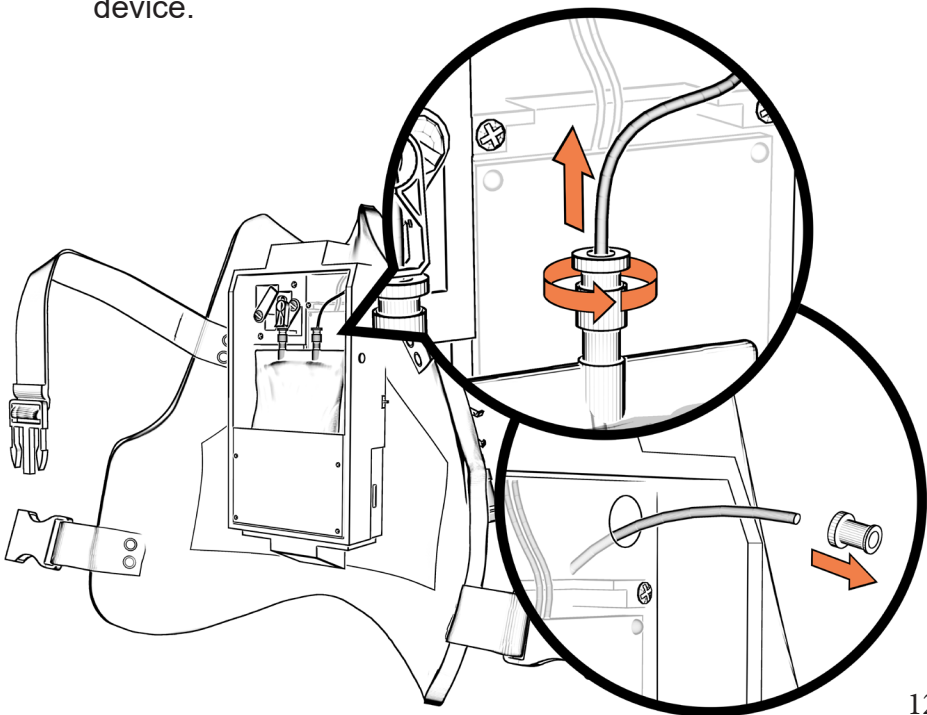

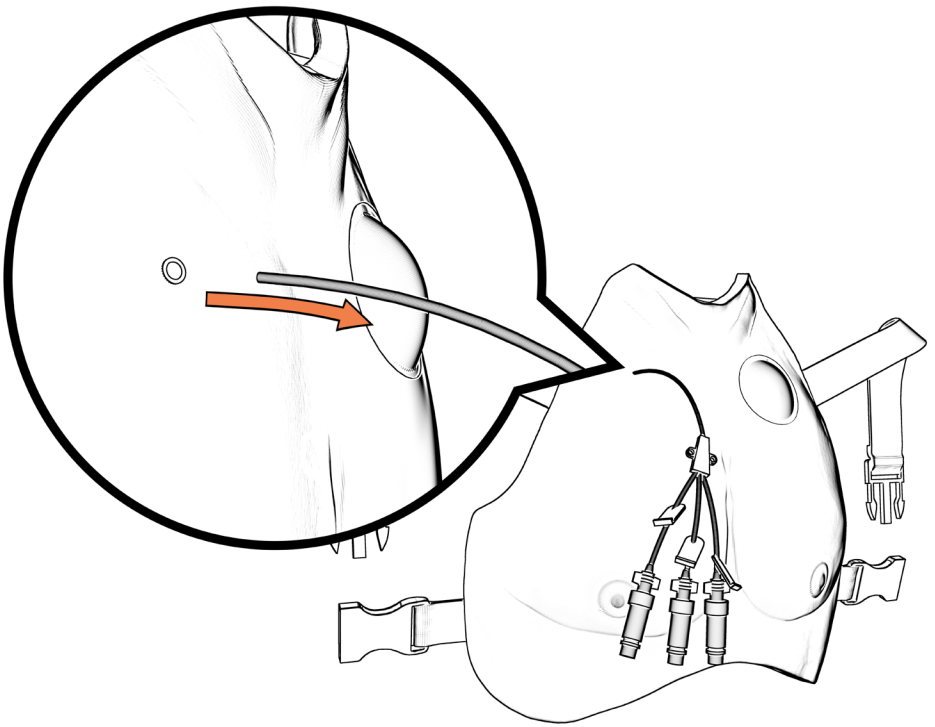

Immediately put the cap back on the central line to prevent losing it.

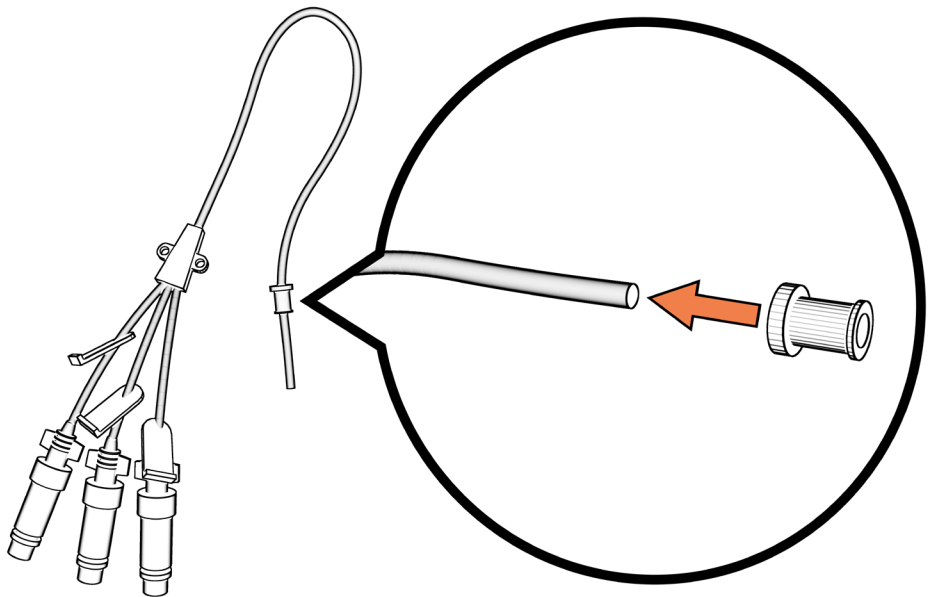

13 Once the blood is hooked up to your selected system, put the Avline on your SP.

14 After the device is on your SP, turn on the device.

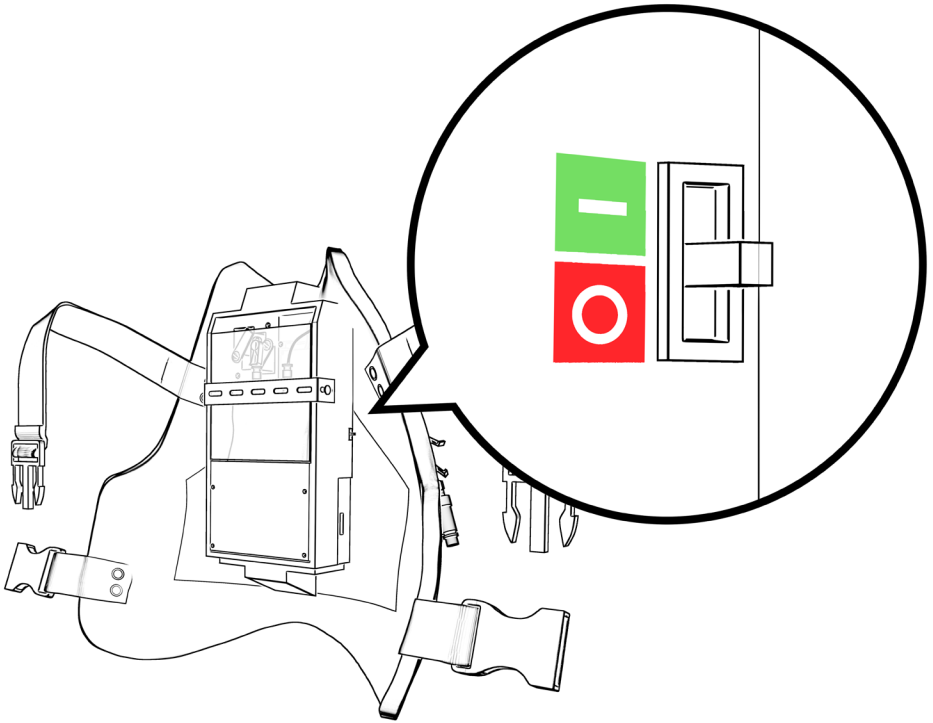

15 Turn on Bluetooth on your apple or android device.

16 Open the Avkin App, select your Avline serial number (located on the chestplate) to connect to your device.

Charging

On the Avkin App, a battery percentage is displayed at the top of the App.

When the battery is at 10% power, the light on the back of Avline turns red indicating the device needs to be charged.

The Avline battery lasts up to 2 full simulation days (16 hours total). The battery requires up to 8 hours to fully charge.

Plug the charger provided in the back of the Avline.

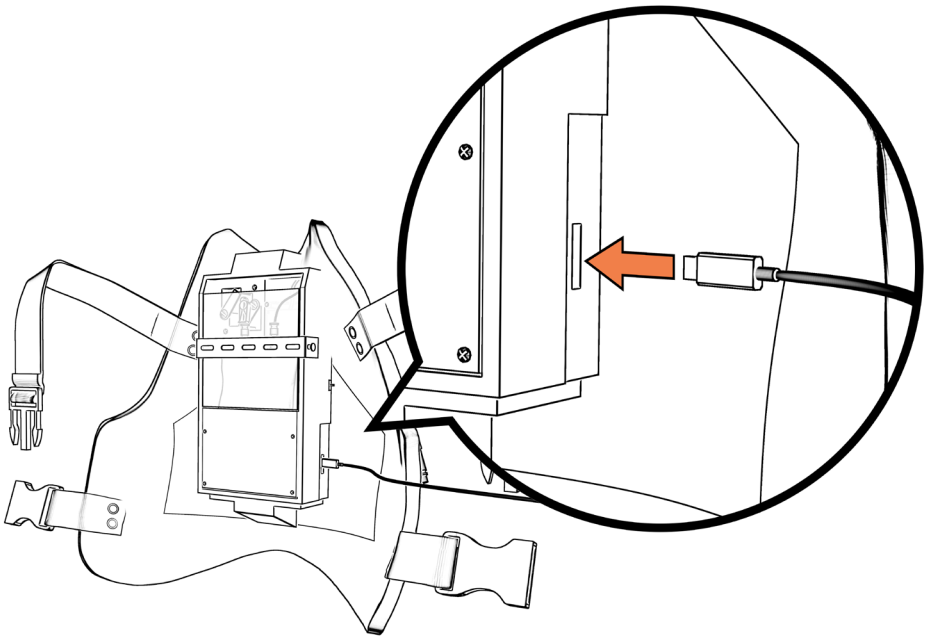

The light will turn yellow when charging and green when charge is complete.

Care and Maintenance

Daily Maintenance

- 1** Remove any marks, moulage or blood on silicone chest.
- 2** Flush distilled water into each port to clean out central line and port-a-cath, follow up by flushing with air.
- 3** Clamp white clamp on tubing from blood bag to port-a-cath.

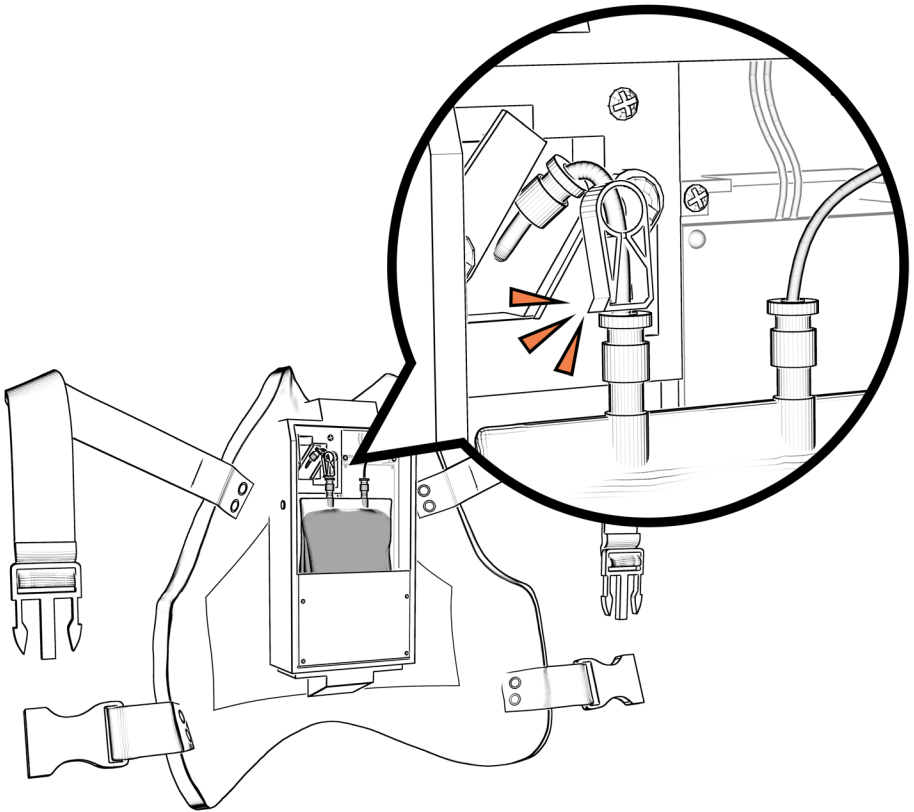

- 4** Remove port-a-cath from device by sliding out port-a-cath housing and disconnecting tubing connection.

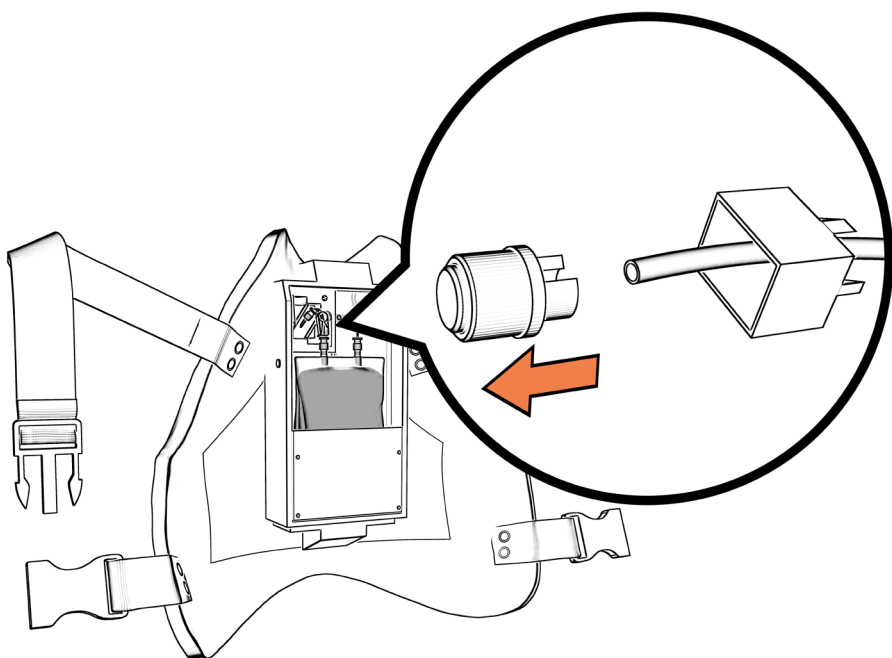

- 5** Remove silicone from port-a-cath and wipe down both the plastic and silicone components. Snap the silicone back into place when complete.

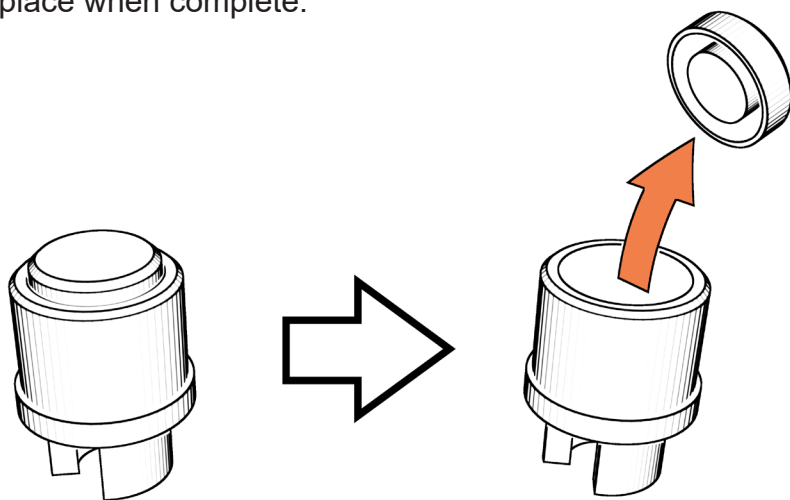

- 6** Replace port-a-cath for the next use.

- 7** For storage, remove the central line from the blood bag and cap the blood bag.
- 8** If port-a-cath skin needs to be replaced, twist out (counter clockwise) current replacement skin.

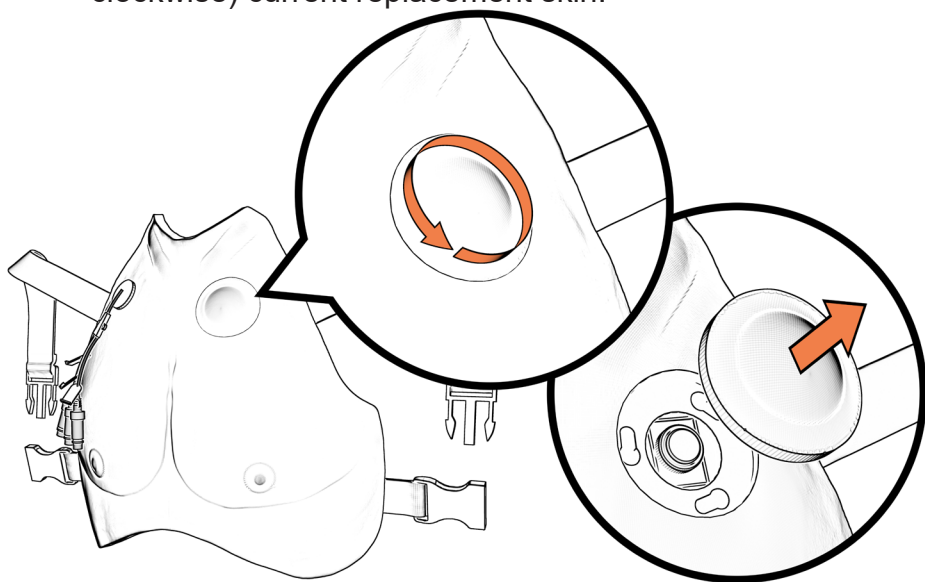

To twist in new replacement skin (clockwise), coat the replacement skin and chest plate with mineral oil.

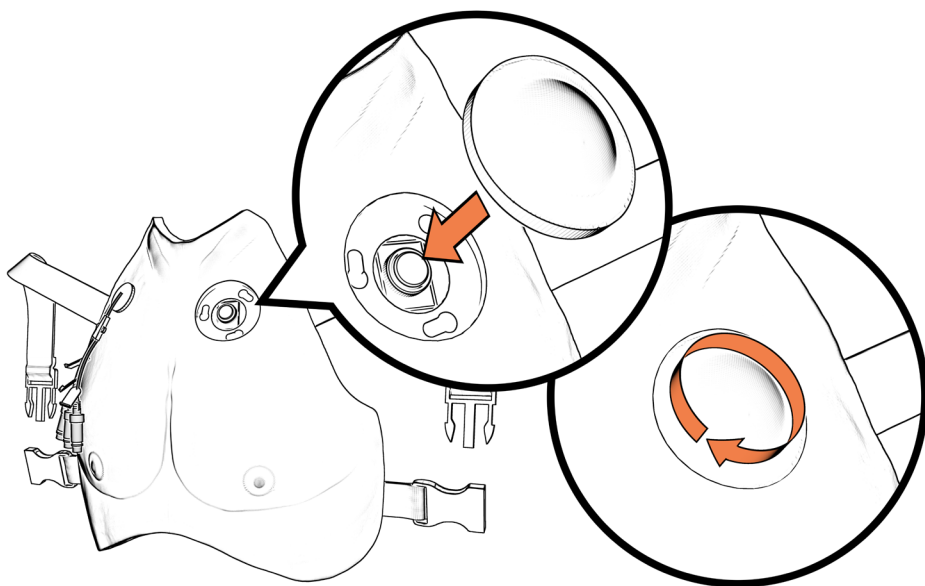

Avline™ is provided by:



www.avkin.com

Battery Life

To provide you with the most accurate data on use when charging of your products we have tested the battery life of each product. We recommend charging your products for at least 8 hours before use to ensure you are able to use products full battery life. Products should be charged every 3 months to maintain battery life.

Avtrach - 6 1/2 hours | Avline - 6 1/2 hours | Avstick - 7 1/2 hours
Avtone - 9 hours | Avcath - 9 hours

*the numbers posted are how long the battery will last if the product is in full use

[Need More Assistance?](#)

(302) 562 - 2040

support@avkin.com



Cleaning Your Devices

All Avkin products are designed to be easy to clean and maintain.

How Do I Clean My Devices?

- > 60% or more alcohol based hand sanitizer
- > Silicone can be wiped down with Sanicloth wipes or hand sanitizer

After Cleaning

- > For light and mid skin tone devices
 - > Dust baby powder or corn starch on the silicone
- > For dark skin tone devices
 - > Dust baby powder or corn starch mixed with no sugar coco powder on the silicone

What Not to Use

- > Do NOT get electronic components wet

Need More Assistance?

(302) 562 - 2040

support@avkin.com

